

5658A12

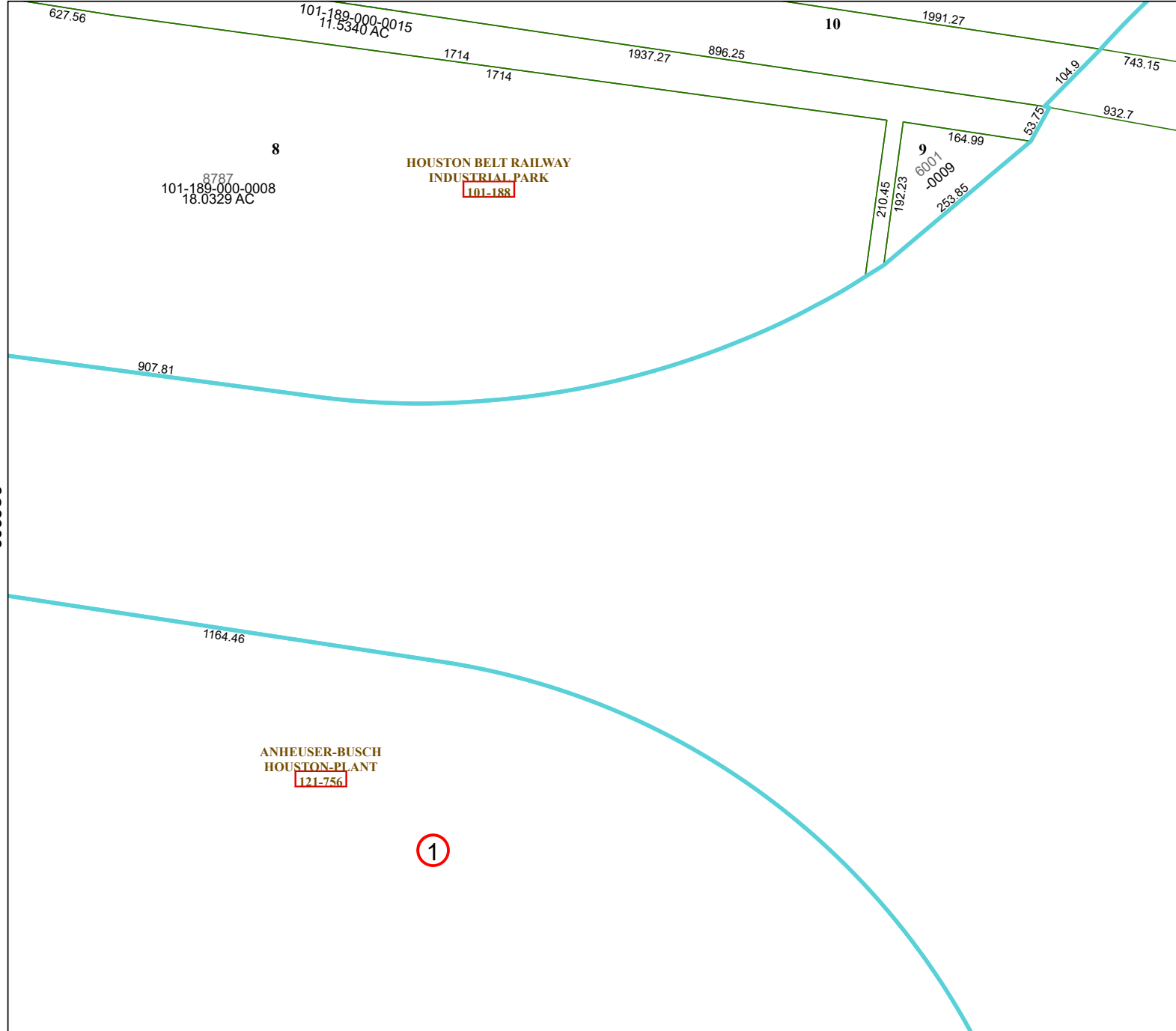

5658C8

5658C3

# Harris Central Appraisal District



0 50 100 200 Feet

PUBLICATION DATE:  
12/16/2025

Geospatial or map data maintained by the Harris Central Appraisal District is for informational purposes and may **not** have been prepared for or be suitable for legal, engineering, or surveying purposes. It does **not** represent an on-the-ground survey and only represents the approximate location of property boundaries.



### MAP LOCATION

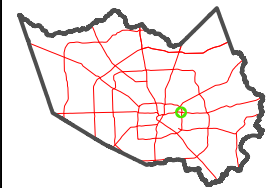

## FACET

### 5658C4

10	11	12	9	10
2	3	4	1	2
6	7	8	5	6