

Harris Central Appraisal District



0 45 90 180 Feet

PUBLICATION DATE: 1/9/2023

Geospatial or map data maintained by the Harris Central Appraisal District is for informational purposes and may not have been prepared for or be suitable for legal, engineering, or surveying purposes. It does not represent an on-the-ground survey and only represents the approximate location of property boundaries.

MAP LOCATION

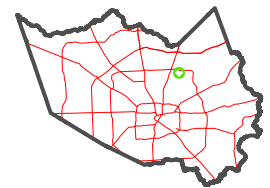

FACET 5664A8

2	3	4	1	2
6	7	8	5	6
10	11	12	9	10

5664A4

5664A12

RES B

HOUSTON SUBURBAN HEIGHTS 017-208
RES C

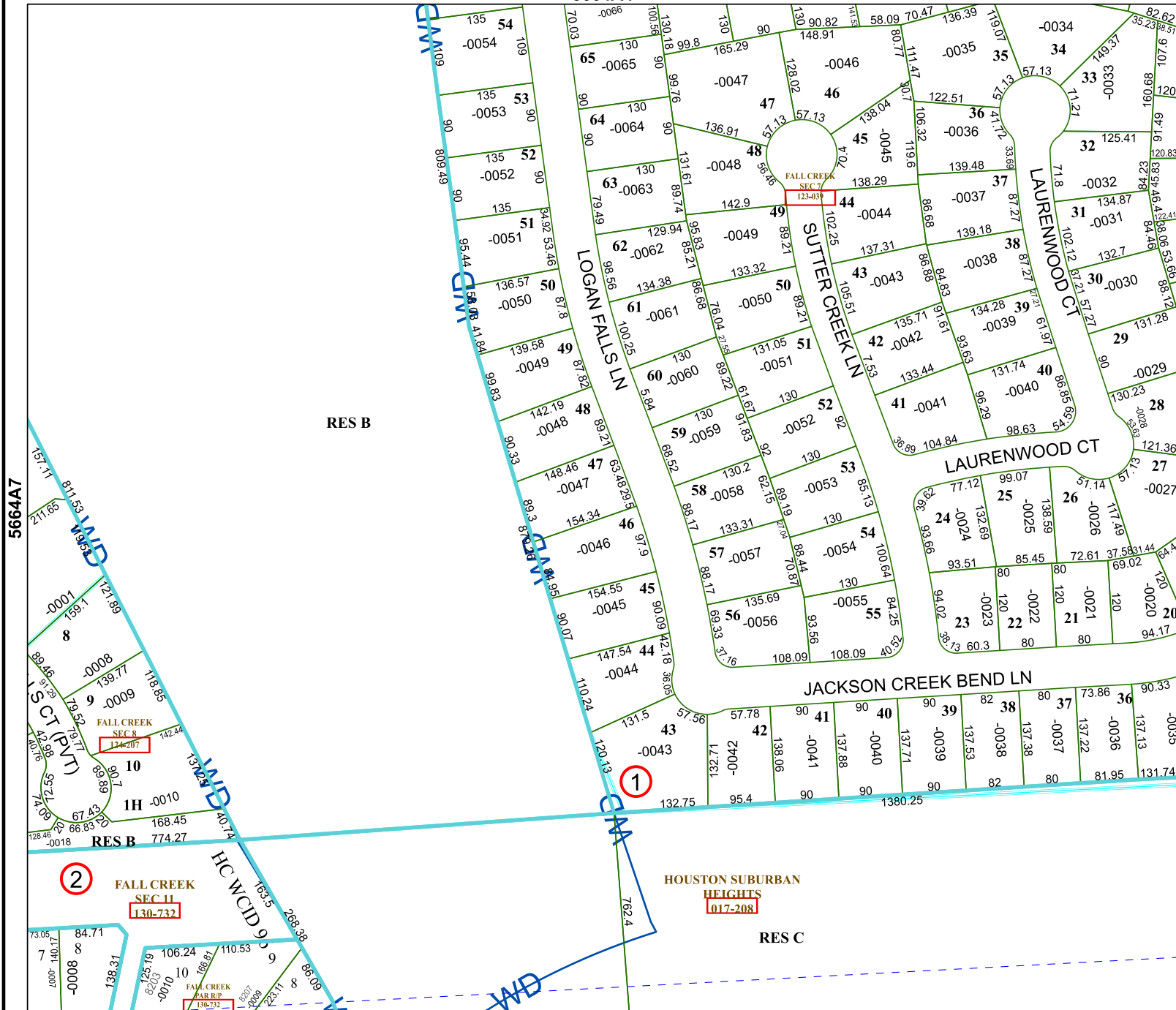

5664A7

5664B5

2

1