

5670D6

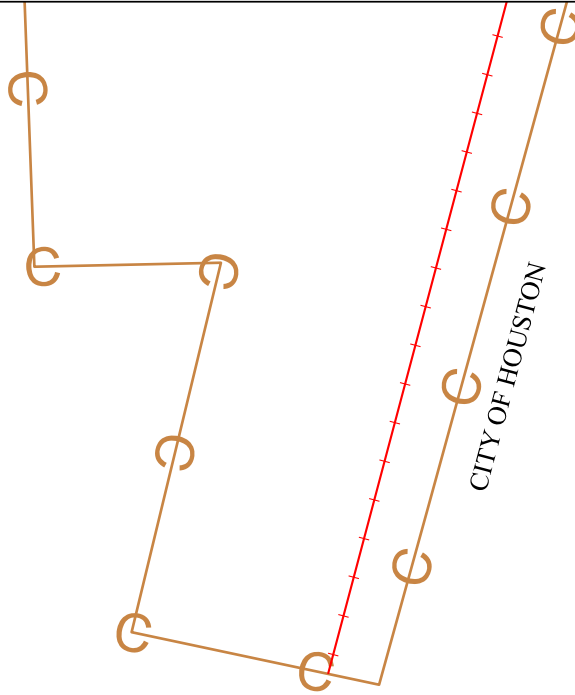

CITY OF HOUSTON

5669B2

5670D9

Harris Central Appraisal District



0 45 90 180 Feet

PUBLICATION DATE:
1/9/2023

Geospatial or map data maintained by the Harris Central Appraisal District is for informational purposes and may **not** have been prepared for or be suitable for legal, engineering, or surveying purposes. It does **not** represent an on-the-ground survey and only represents the approximate location of property boundaries.



5670D11

MAP LOCATION

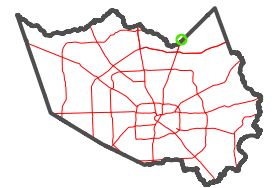

FACET 5670D10

	5	6	7	8
	9	10	11	12
4	1	2	3	4