

Harris Central Appraisal District



0 45 90 180 Feet

PUBLICATION DATE: 1/9/2023

Geospatial or map data maintained by the Harris Central Appraisal District is for informational purposes and may not have been prepared for or be suitable for legal, engineering, or surveying purposes. It does not represent an on-the-ground survey and only represents the approximate location of property boundaries.

MAP LOCATION

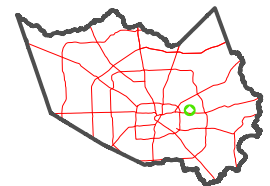

FACET 5758B5

3	4	1	2	3
7	8	5	6	7
11	12	9	10	11

5758B1

5758B9

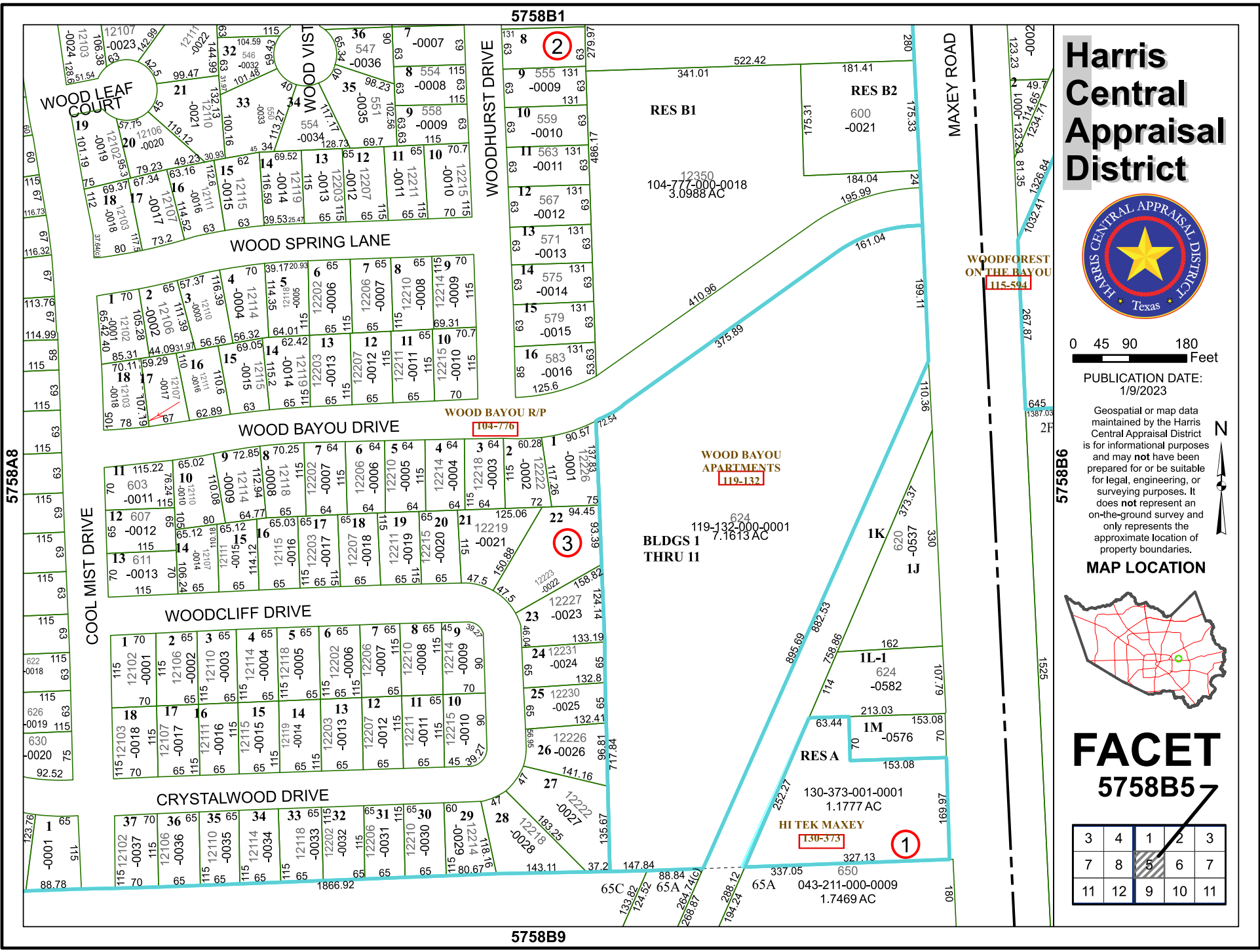

5758A8

5758B5

5758B7

5758B8

5758B9

5758B0