

Harris Central Appraisal District



0 45 90 180 Feet

PUBLICATION DATE: 12/30/2023

Geospatial or map data maintained by the Harris Central Appraisal District is for informational purposes and may not be suitable for legal, engineering, or surveying purposes. It does not represent an on-the-ground survey and only represents the approximate location of property boundaries.

MAP LOCATION

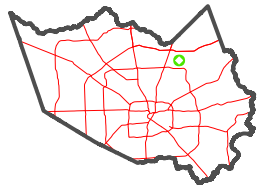

FACET 5766C2

12	9	10	11	12
4	1	2	3	4
8	5	6	7	8

5766A10

5766C6

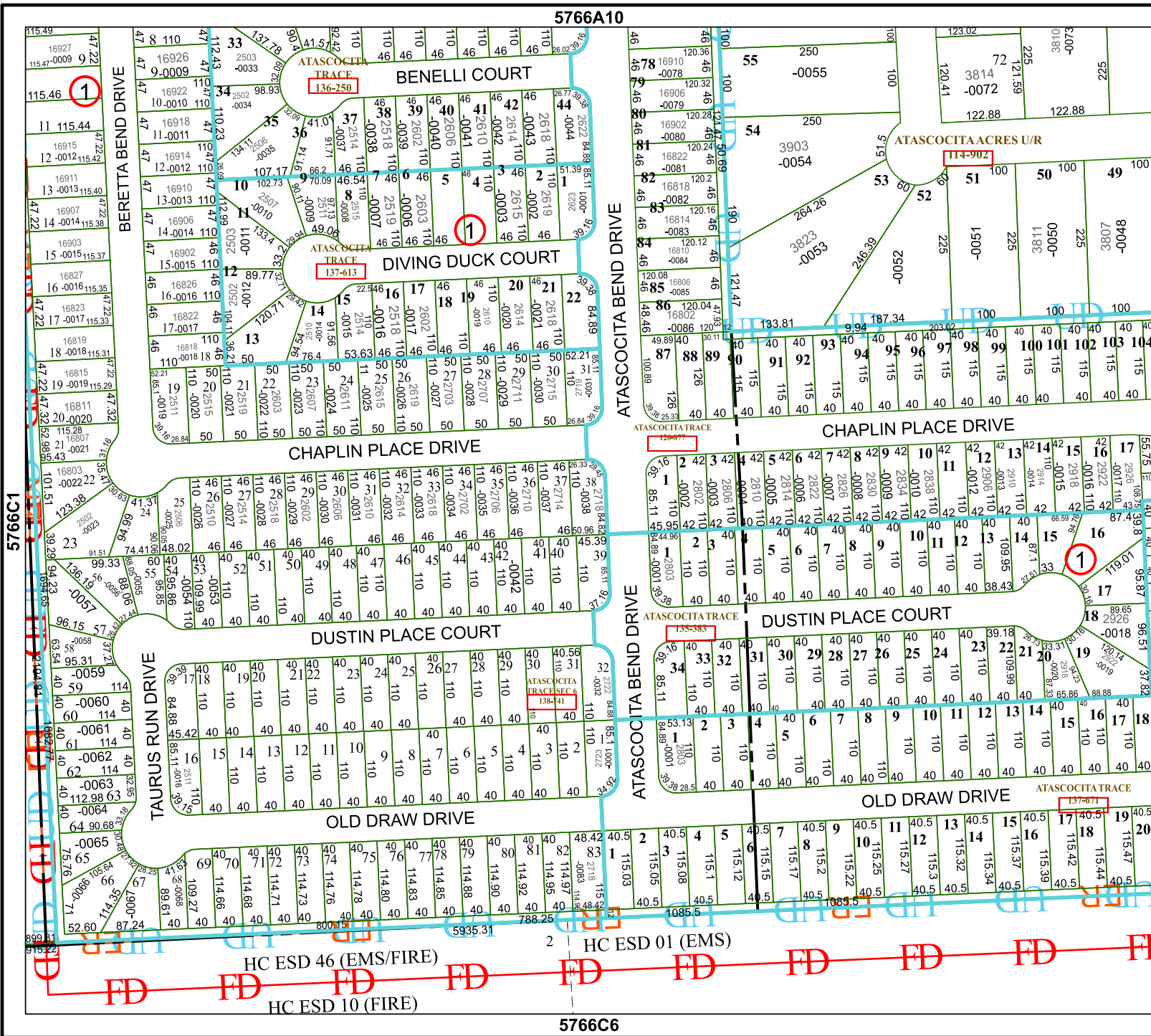

5766C1

5766C2

5766C3

5766C4

5766C5

5766C6