

Harris Central Appraisal District



0 45 90 180 Feet

PUBLICATION DATE:
5/11/2023

Geospatial or map data maintained by the Harris Central Appraisal District is for informational purposes and may not have been prepared for or be suitable for legal, engineering, or surveying purposes. It does not represent an on-the-ground survey and only represents the approximate location of property boundaries.

MAP LOCATION

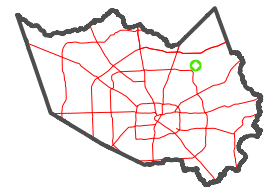

FACET 5865A2

12	9	10	11	12
4	1	2	3	4
8	5	6	7	8

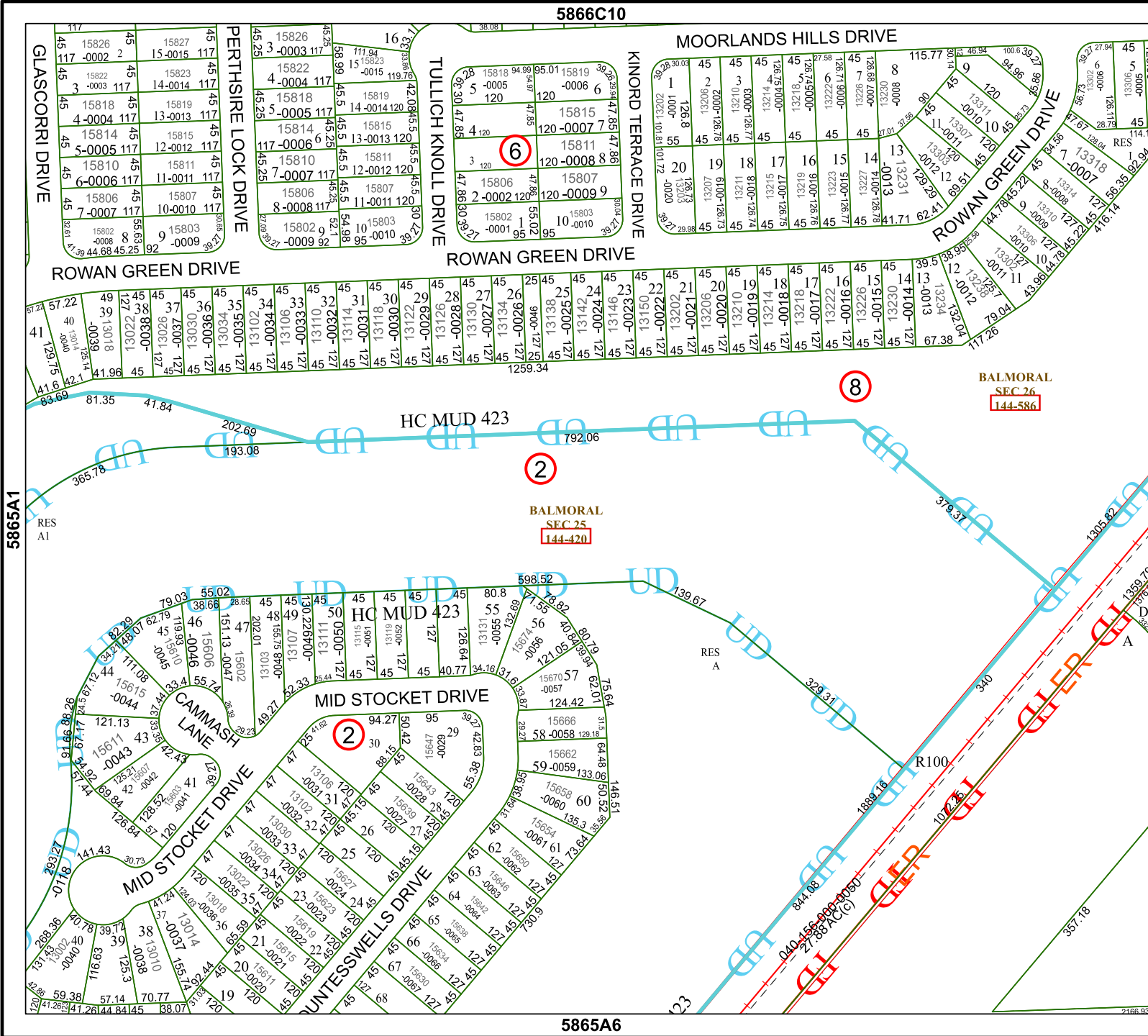

5866C10

5865A1

5865A6

5865A3

6

8

2

2

BALMORAL
SEC 25
144-420

BALMORAL
SEC 26
144-586

HC MUD 423

MID STOCKET DRIVE

CAMMASH LANE

MID STOCKET DRIVE

UNTESWELLS DRIVE

R100

156600-00050

27-68 AC (G)

CLIPPER CREEK

CLIPPER CREEK

CLIPPER CREEK

CLIPPER CREEK

CLIPPER CREEK

CLIPPER CREEK

CLIPPER CREEK

CLIPPER CREEK

CLIPPER CREEK

CLIPPER CREEK