

Harris Central Appraisal District



0 45 90 180 Feet

PUBLICATION DATE:
3/13/2023

Geospatial or map data maintained by the Harris Central Appraisal District is for informational purposes and may not have been prepared for or be suitable for legal, engineering, or surveying purposes. It does not represent an on-the-ground survey and only represents the approximate location of property boundaries.

MAP LOCATION

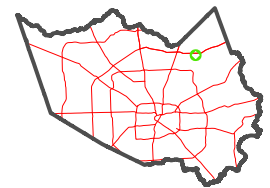

FACET 5867A10

8	5	6	7	8
12	9	10	11	12
4	1	2	3	4

5867A6

5867C2

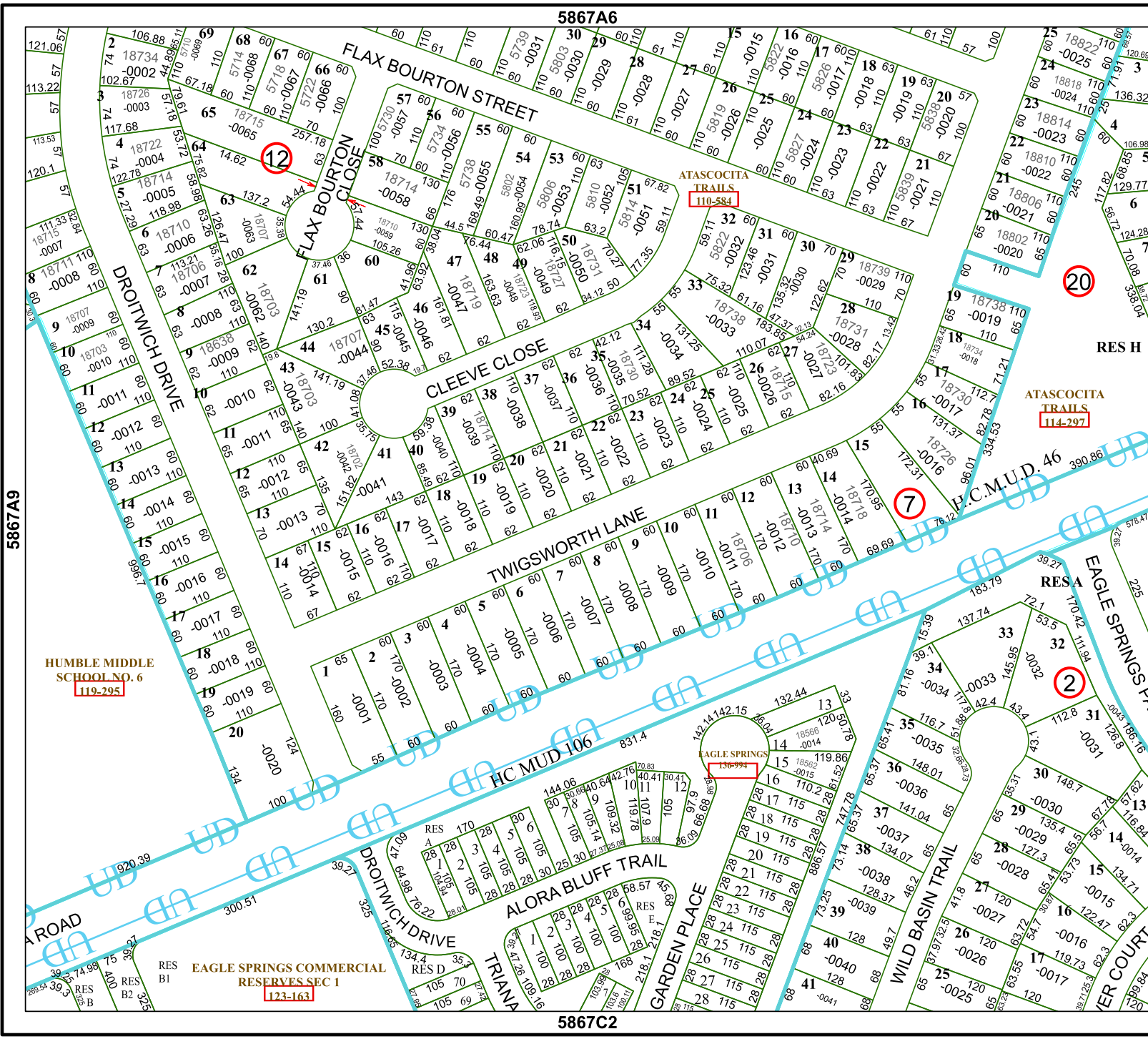

20

7

2

12

136-993

123-163

110-584

114-297

HUMBLE MIDDLE SCHOOL NO. 6
119-295

EAGLE SPRINGS COMMERCIAL RESERVES SEC 1
123-163

EAGLE SPRINGS
136-993

RES H

RES A

RES B1

RES B2

RES D

RES E

RES F

RES G

RES I

RES J

RES K

RES L

RES M

RES N

RES O

RES P

RES Q

RES R

RES S

RES T

RES U

RES V

RES W

RES X

RES Y

RES Z

