

Harris Central Appraisal District



0 45 90 180 Feet

PUBLICATION DATE:
12/30/2023

Geospatial or map data maintained by the Harris Central Appraisal District is for informational purposes and may not have been prepared for or be suitable for legal, engineering, or surveying purposes. It does not represent an on-the-ground survey and only represents the approximate location of property boundaries.



MAP LOCATION

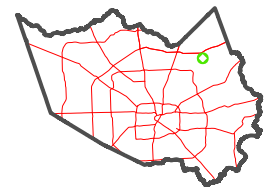

FACET 5867D12

6	7	8	5	6
10	11	12	9	10
2	3	4	1	2

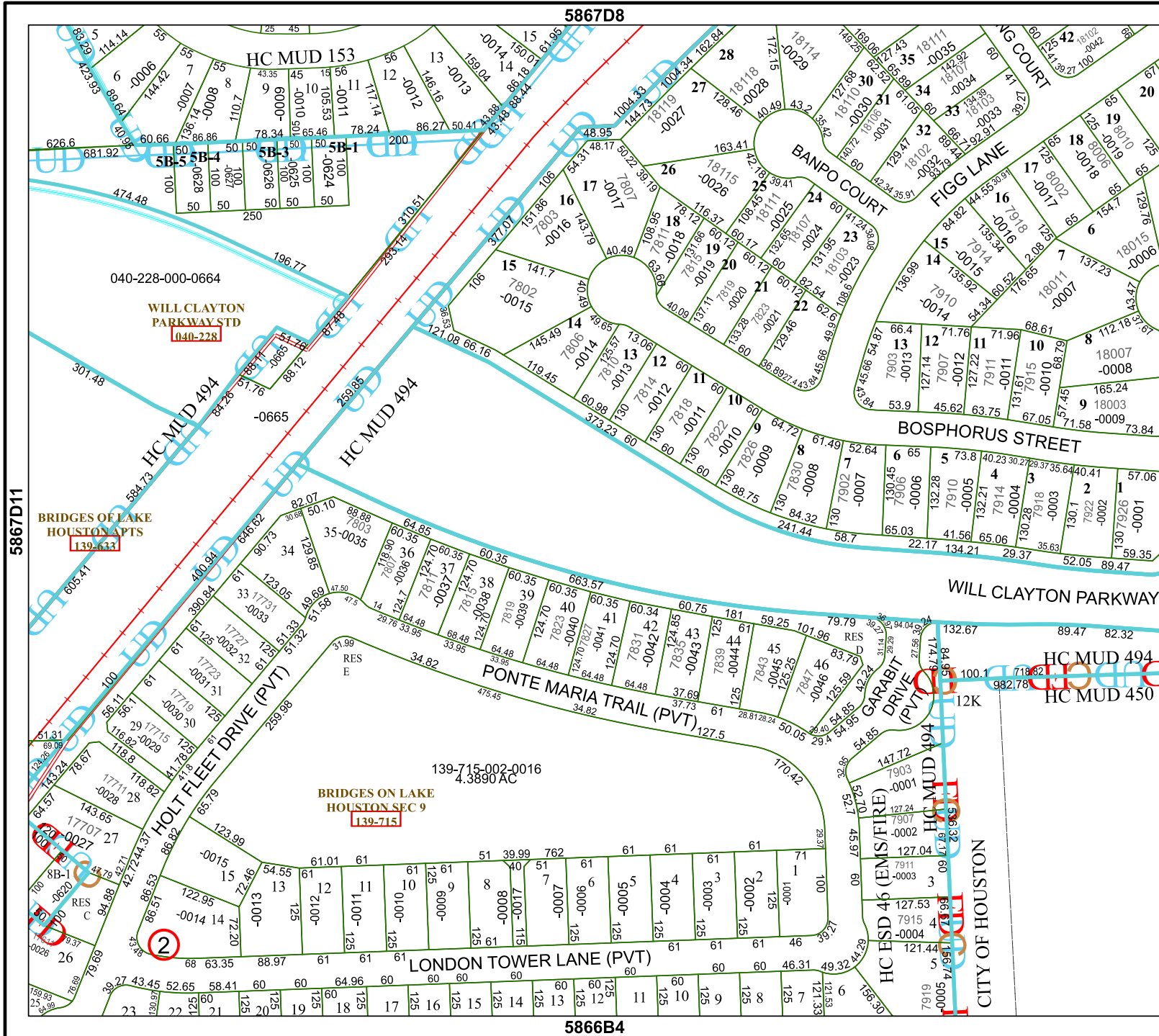

040-228-000-0664

**WILL CLAYTON
PARKWAY STD**
040-228

**BRIDGES OF LAKE
HOUSTON APTS**
139-633

5867D11

139-715-002-0016
4.3890 AC

**BRIDGES ON LAKE
HOUSTON SEC 9**
139-715

2

5866B4

5967C9

CITY OF HOUSTON