

# Harris Central Appraisal District



0 45 90 180 Feet

PUBLICATION DATE:  
4/11/2023

Geospatial or map data maintained by the Harris Central Appraisal District is for informational purposes and may not have been prepared for or be suitable for legal, engineering, or surveying purposes. It does not represent an on-the-ground survey and only represents the approximate location of property boundaries.

MAP LOCATION

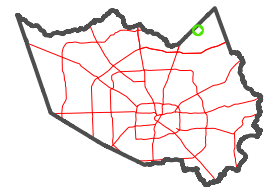

## FACET 5871A12

6	7	8	5	6
10	11	12	9	10
2	3	4	1	2

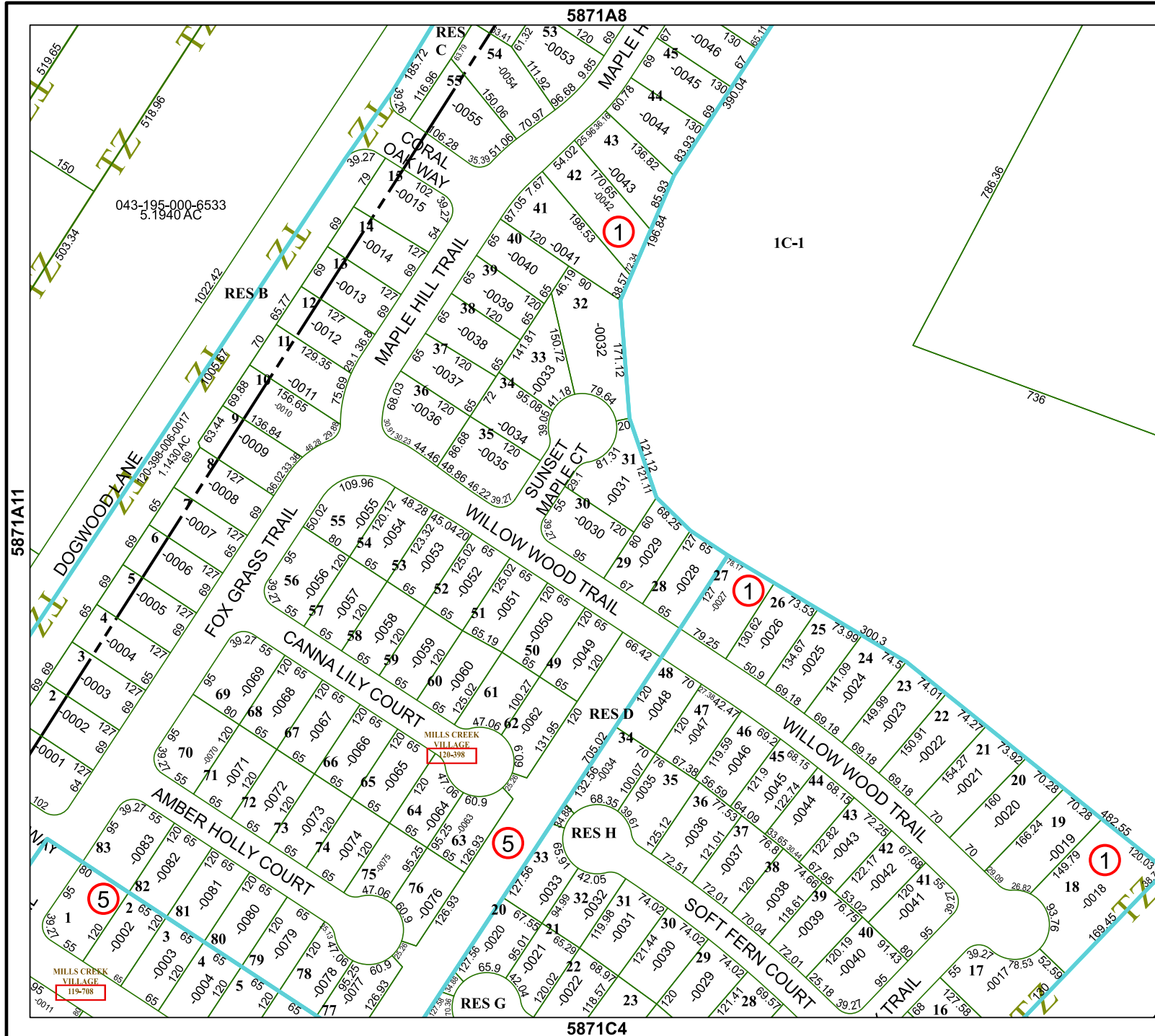

5871A8

I-C-1

5871C4

043-195-000-6533  
5.1940 AC

MILLS CREEK  
VILLAGE  
119-708

MILLS CREEK  
VILLAGE  
208-998