

5958D4

137-386-001-0003

CPS HOUSTON
137-386

Harris Central Appraisal District



0 45 90 180
Feet

PUBLICATION DATE:
5/6/2024

Geospatial or map data maintained by the Harris Central Appraisal District is for informational purposes and may not have been prepared for or be suitable for legal, engineering, or surveying purposes. It does not represent an on-the-ground survey and only represents the approximate location of property boundaries.



MAP LOCATION

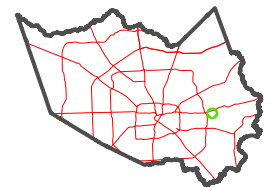

FACET 5958D8

2	3	4	1	2
6	7	8	5	6
10	11	12	9	10

5958D7

6058C5

SAN JACINTO
ORDINANCE DEPOT
041-032

040-240-005-0133
18.0000 AC

041-032-001-0038
12.6479 AC

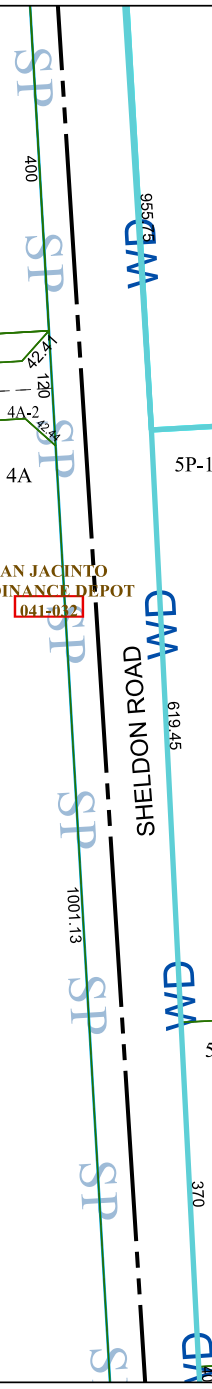

5958D12

1619.97