

Harris Central Appraisal District



0 45 90 180 Feet

PUBLICATION DATE: 1/3/2023

Geospatial or map data maintained by the Harris Central Appraisal District is for informational purposes and may not have been prepared for or be suitable for legal, engineering, or surveying purposes. It does not represent an on-the-ground survey and only represents the approximate location of property boundaries.

MAP LOCATION

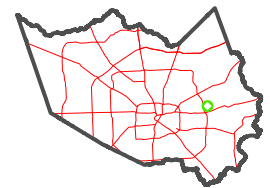

FACET 5959C4

10	11	12	9	10
2	3	4	1	2
6	7	8	5	6

5959A12

5959C8

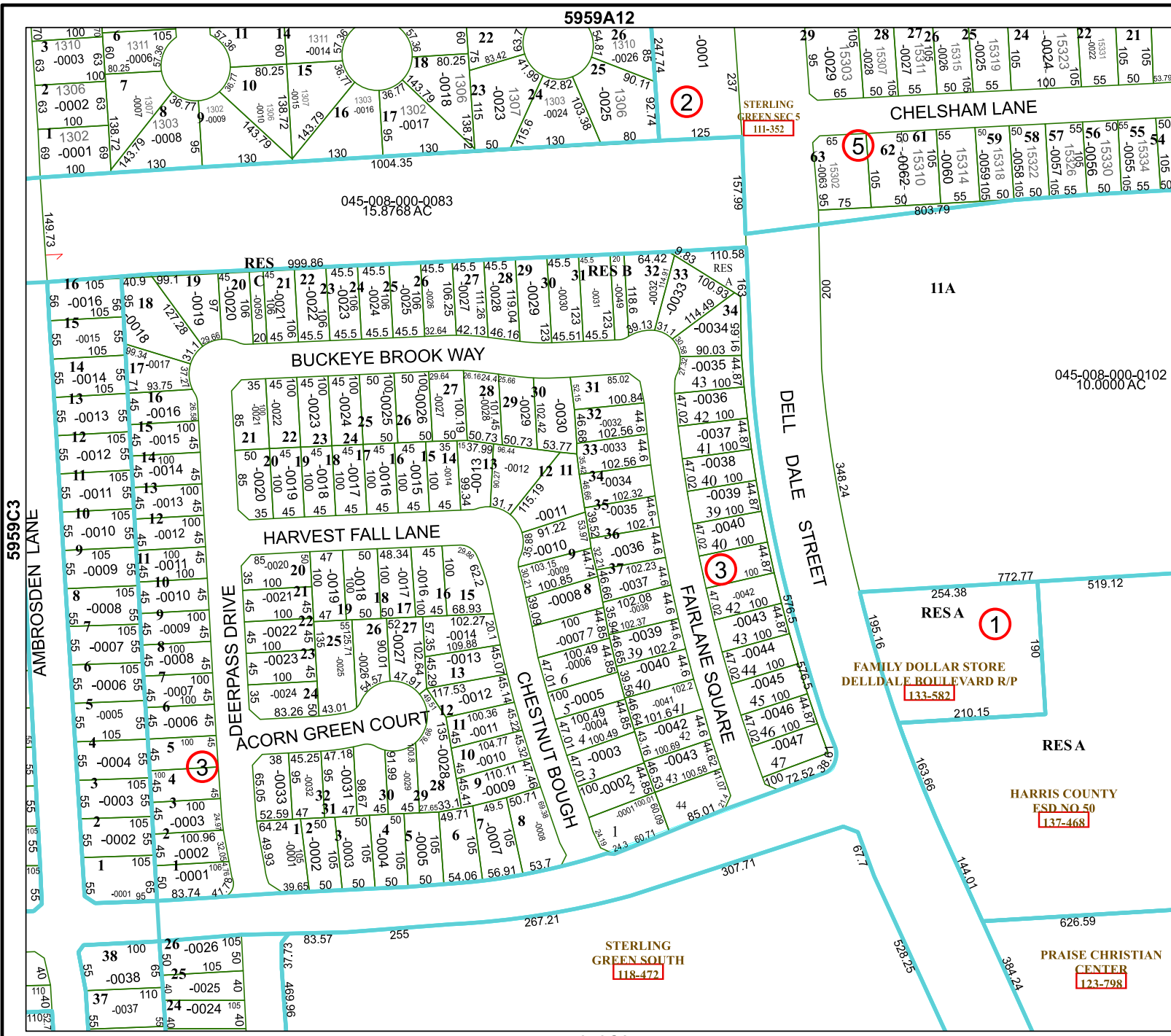

STERLING GREEN SEC 5
111-352

STERLING GREEN SOUTH
118-472

FAMILY DOLLAR STORE
DELLDALE BOULEVARD R/P
133-582

HARRIS COUNTY
ESD NO 50
137-468

PRAISE CHRISTIAN
CENTER
123-798

5959C3

1D6565