

5964B10

40

5964D1

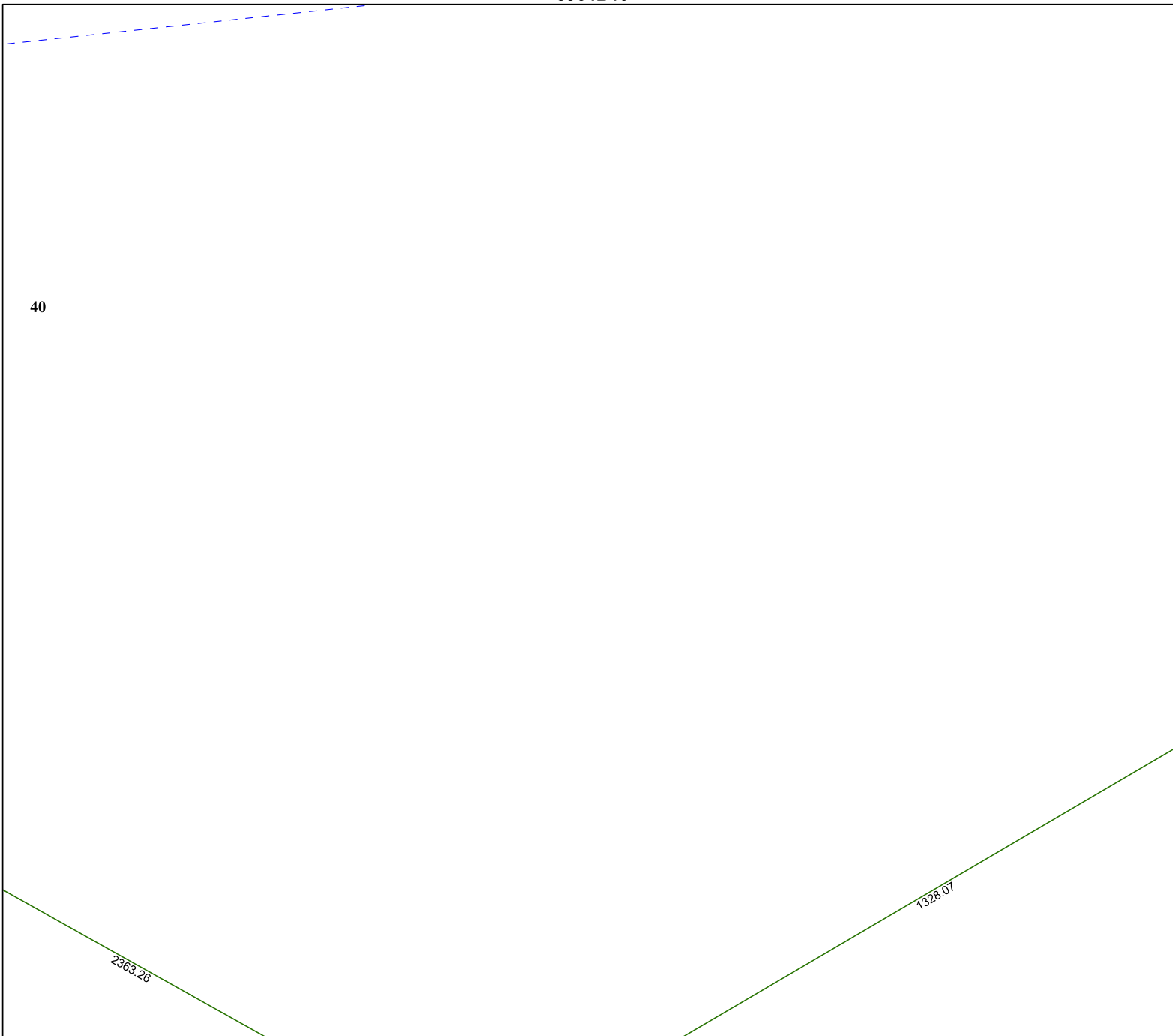

5964D6

# Harris Central Appraisal District



0 45 90 180  
Feet

PUBLICATION DATE:  
1/3/2023

Geospatial or map data maintained by the Harris Central Appraisal District is for informational purposes and may **not** have been prepared for or be suitable for legal, engineering, or surveying purposes. It does **not** represent an on-the-ground survey and only represents the approximate location of property boundaries.



5964D3

## MAP LOCATION

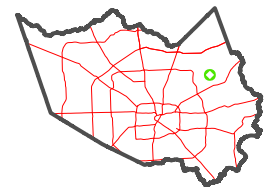

## FACET 5964D2

12	9	10	11	12
4	1	2	3	4
8	5	6	7	8