

# Harris Central Appraisal District



0 45 90 180 Feet

PUBLICATION DATE:  
1/4/2023

Geospatial or map data maintained by the Harris Central Appraisal District is for informational purposes and may not have been prepared for or be suitable for legal, engineering, or surveying purposes. It does not represent an on-the-ground survey and only represents the approximate location of property boundaries.

MAP LOCATION

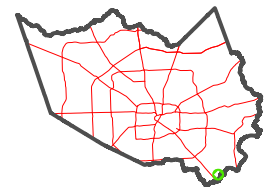

## FACET 6048D1

11	12	9	10	11
3	4	1	2	3
7	8	5	6	7

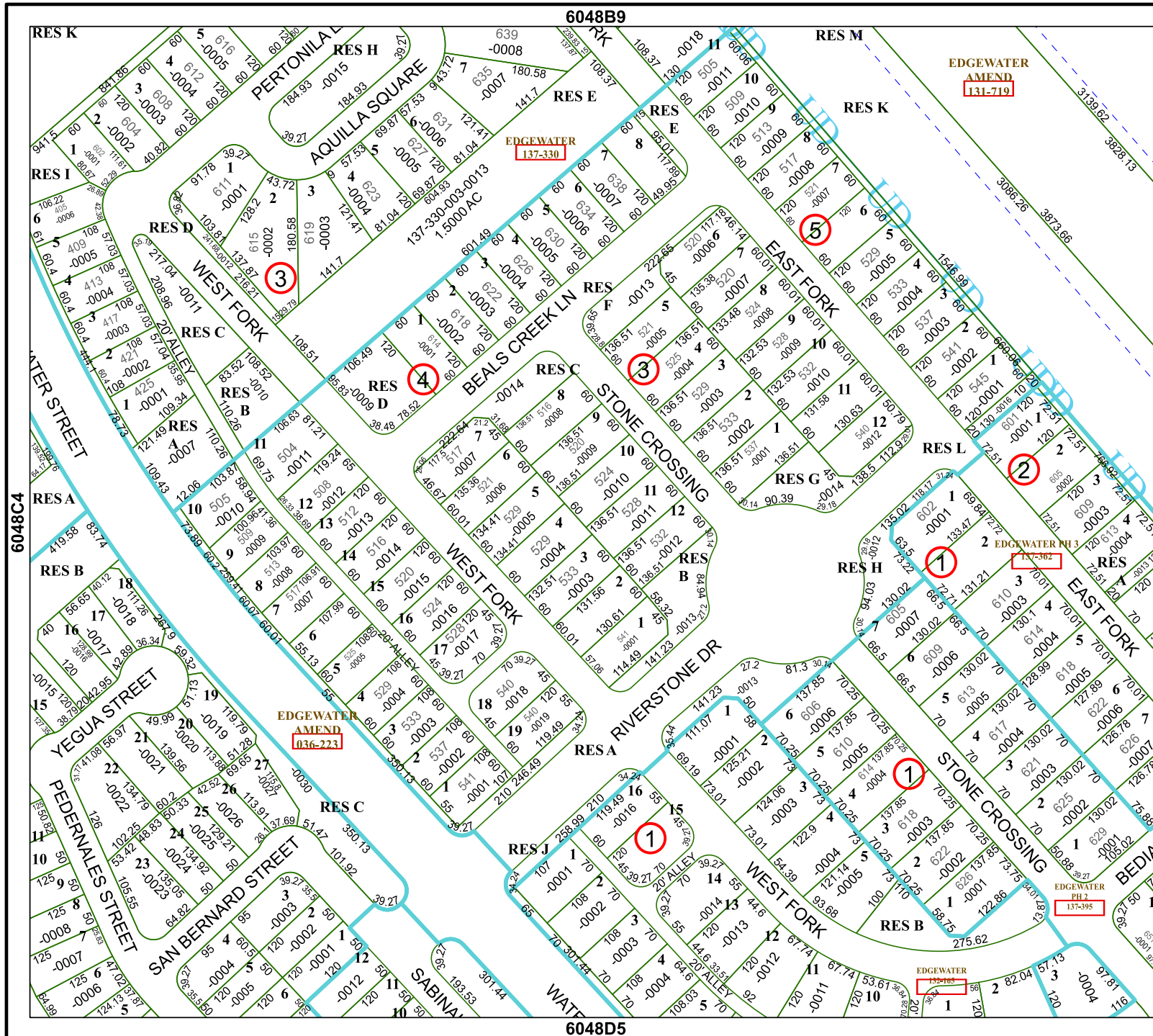

6048B9

EDGEWATER AMEND 131-719

EDGEWATER 137-330

EDGEWATER AMEND 136-223

EDGEWATER PH 2 137-395

6048D5