

Harris Central Appraisal District



0 45 90 180 Feet

PUBLICATION DATE:
1/4/2023

Geospatial or map data maintained by the Harris Central Appraisal District is for informational purposes and may not have been prepared for or be suitable for legal, engineering, or surveying purposes. It does not represent an on-the-ground survey and only represents the approximate location of property boundaries.

MAP LOCATION

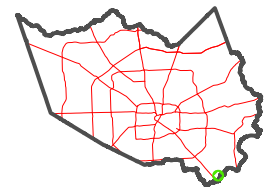

FACET 6048D5

3	4	1	2	3
7	8	5	6	7
11	12	9	10	11

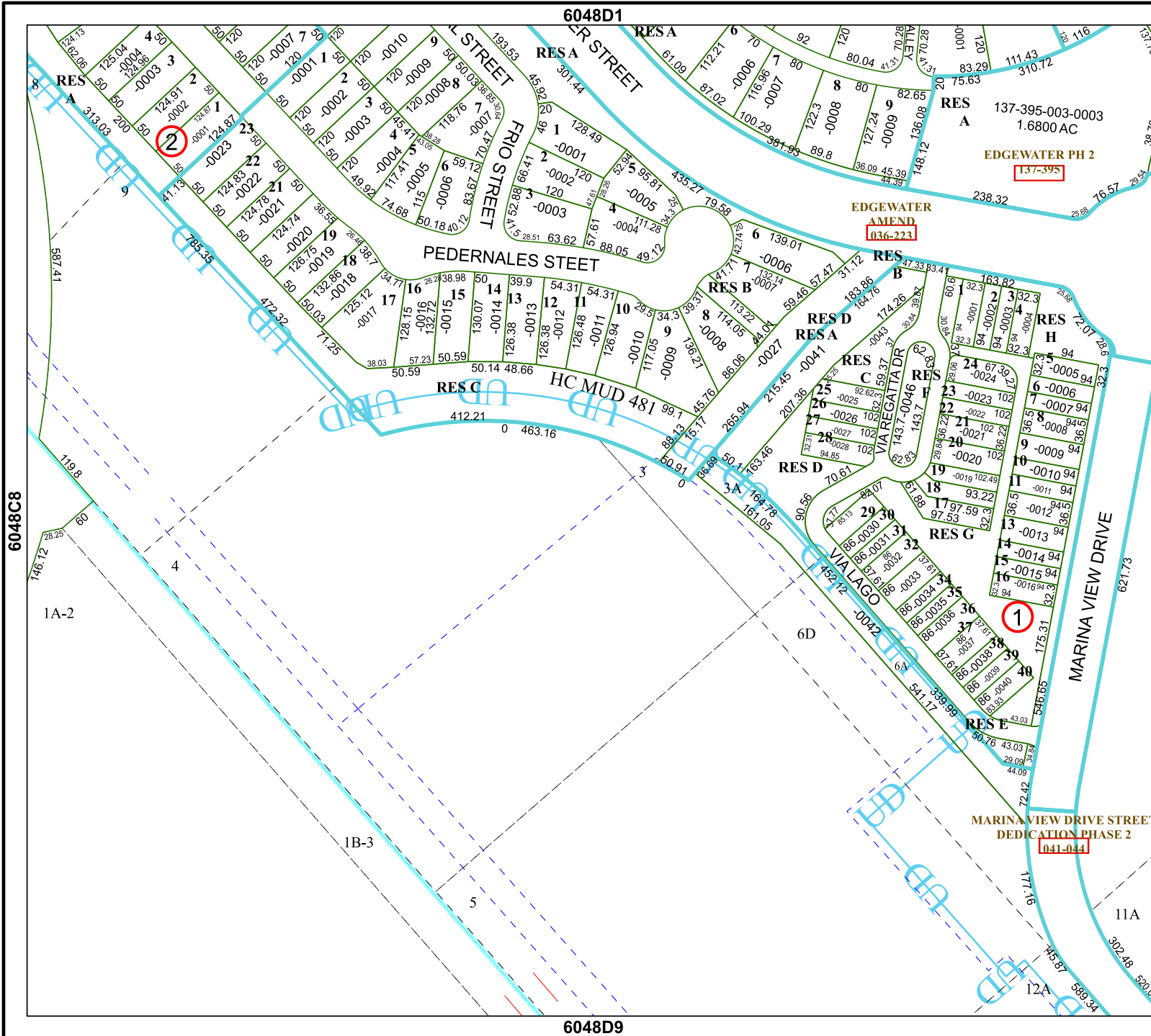

6048D1

6048D9

6048C8

6048D6

MARINA VIEW DRIVE

MARINA VIEW DRIVE STREET DEDICATION PHASE 2

EDGEMUD 481

EDGEMUD PH 2

AMEND

036-223

137-395

137-395-003-0003
1.6800 AC

137-395

036-223

036-223

036-223

036-223

036-223

036-223

036-223

036-223

036-223

036-223

036-223

036-223

036-223

036-223

036-223

036-223

036-223

036-223

036-223

036-223

036-223

036-223

036-223

036-223

036-223

036-223

036-223

036-223