

6056A3

6056A6

044.05  
1000  
269.5500 AC

CITY OF HOUSTON

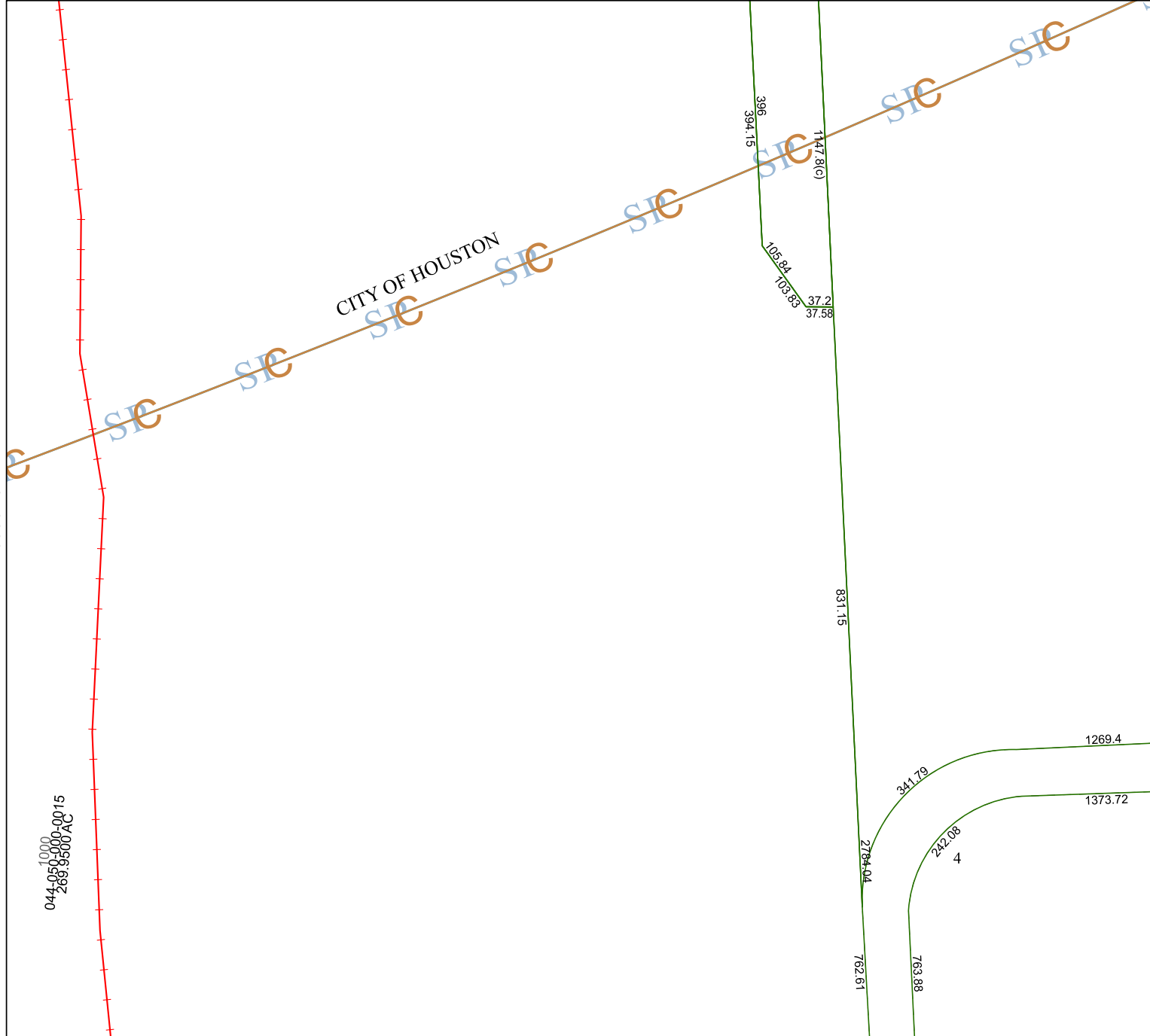

6056A11

# Harris Central Appraisal District



0 45 90 180 Feet

PUBLICATION DATE:  
1/4/2023

Geospatial or map data maintained by the Harris Central Appraisal District is for informational purposes and may **not** have been prepared for or be suitable for legal, engineering, or surveying purposes. It does **not** represent an on-the-ground survey and only represents the approximate location of property boundaries.



## MAP LOCATION

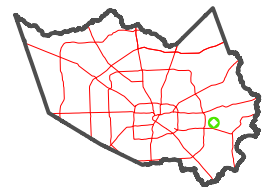

# FACET 6056A7

1	2	3	4	1
5	6	7	8	5
9	10	11	12	9