

6057D8

1A

Harris Central Appraisal District



0 45 90 180 Feet

PUBLICATION DATE:
1/4/2023

Geospatial or map data maintained by the Harris Central Appraisal District is for informational purposes and may not have been prepared for or be suitable for legal, engineering, or surveying purposes. It does not represent an on-the-ground survey and only represents the approximate location of property boundaries.



MAP LOCATION

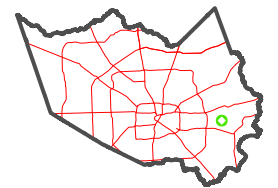

FACET 6057D12

6	7	8	5	6
10	11	12	9	10
2	3	4	1	2

6056B4

6057D11

6157C9

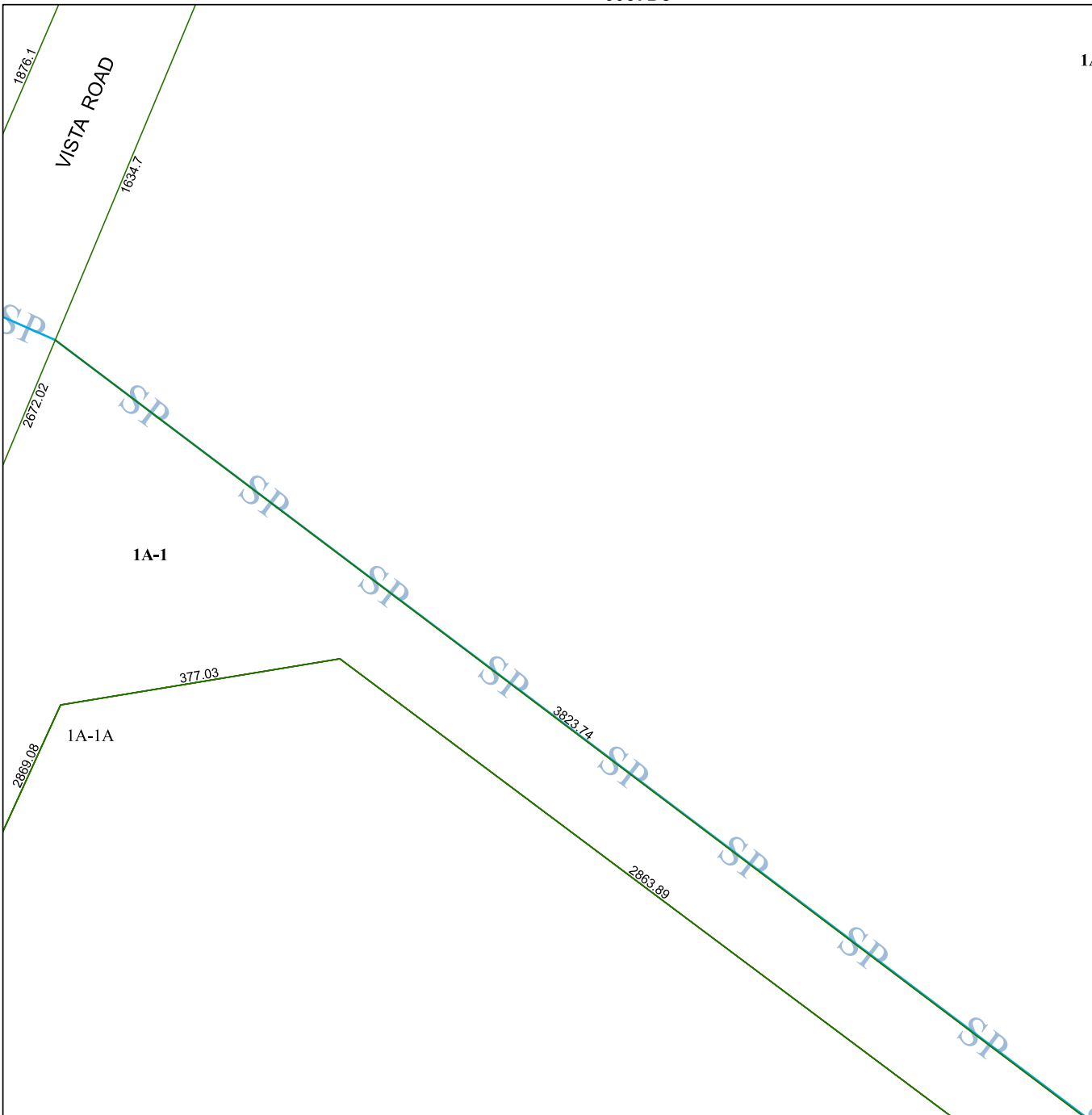

1A-1

1A-1A