

6151B8

PORT ROAD

R100

BAYPORT
SEC 11/R
100-515

6151D4

6151B11

Harris Central Appraisal District



0 45 90 180
Feet

PUBLICATION DATE:
1/4/2023

Geospatial or map data maintained by the Harris Central Appraisal District is for informational purposes and may not have been prepared for or be suitable for legal, engineering, or surveying purposes. It does not represent an on-the-ground survey and only represents the approximate location of property boundaries.



MAP LOCATION

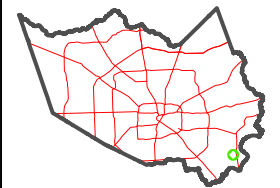

FACET

6151B12

6	7	8	5	6
10	11	12	9	10
2	3	4	1	2

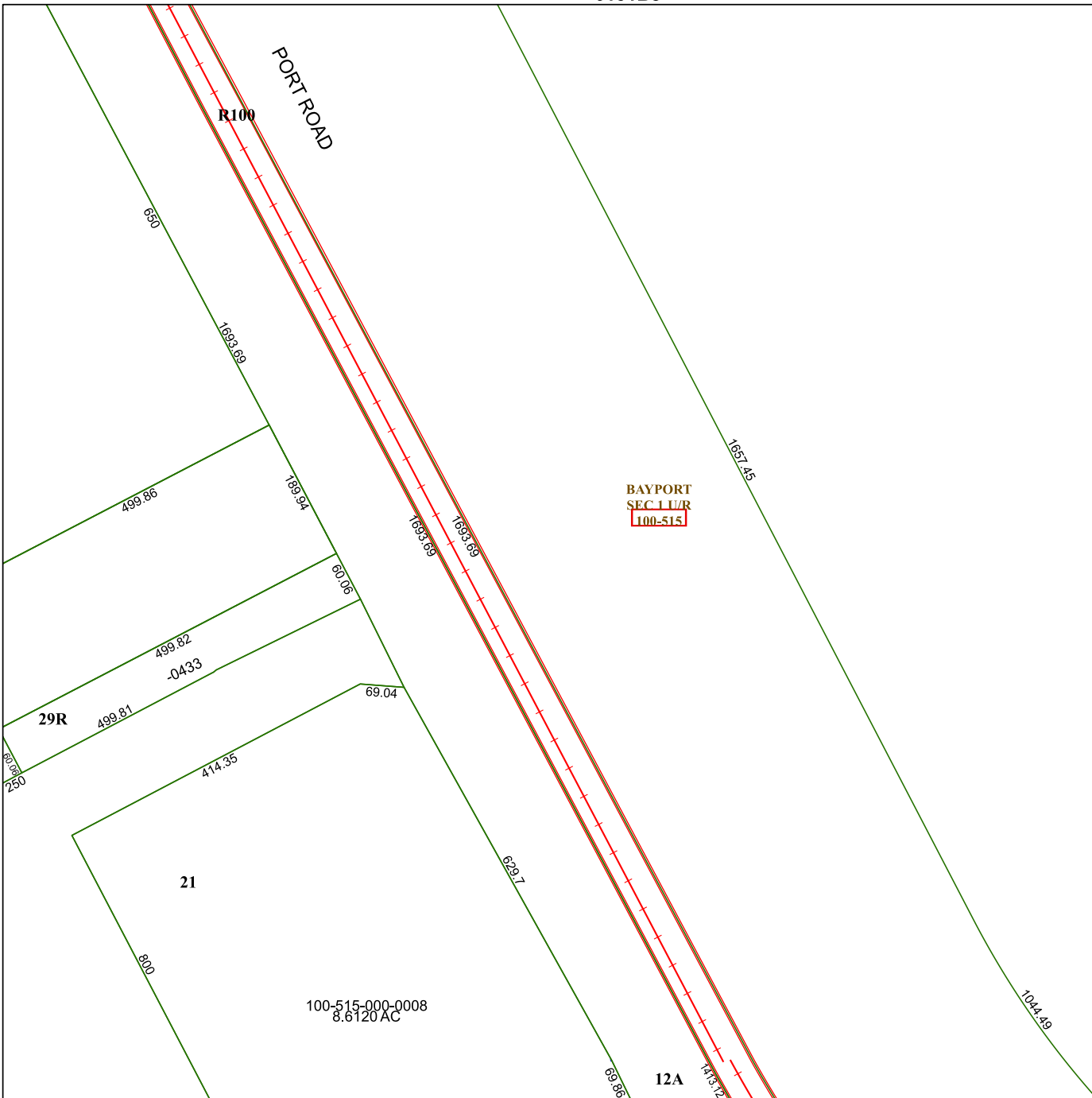

6251A9