

6152D7

48.31	315.69	43.91
9D-1	-1032	314.9

9D

6152D10

Harris Central Appraisal District



0 45 90 180 Feet

PUBLICATION DATE:
4/22/2024

Geospatial or map data maintained by the Harris Central Appraisal District is for informational purposes and may not have been prepared for or be suitable for legal, engineering, or surveying purposes. It does not represent an on-the-ground survey and only represents the approximate location of property boundaries.



MAP LOCATION

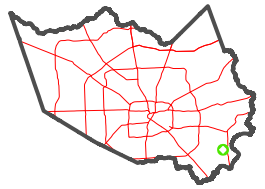

FACET 6152D11

5	6	7	8	5
9	10	11	12	9
1	2	3	4	1

6151B3

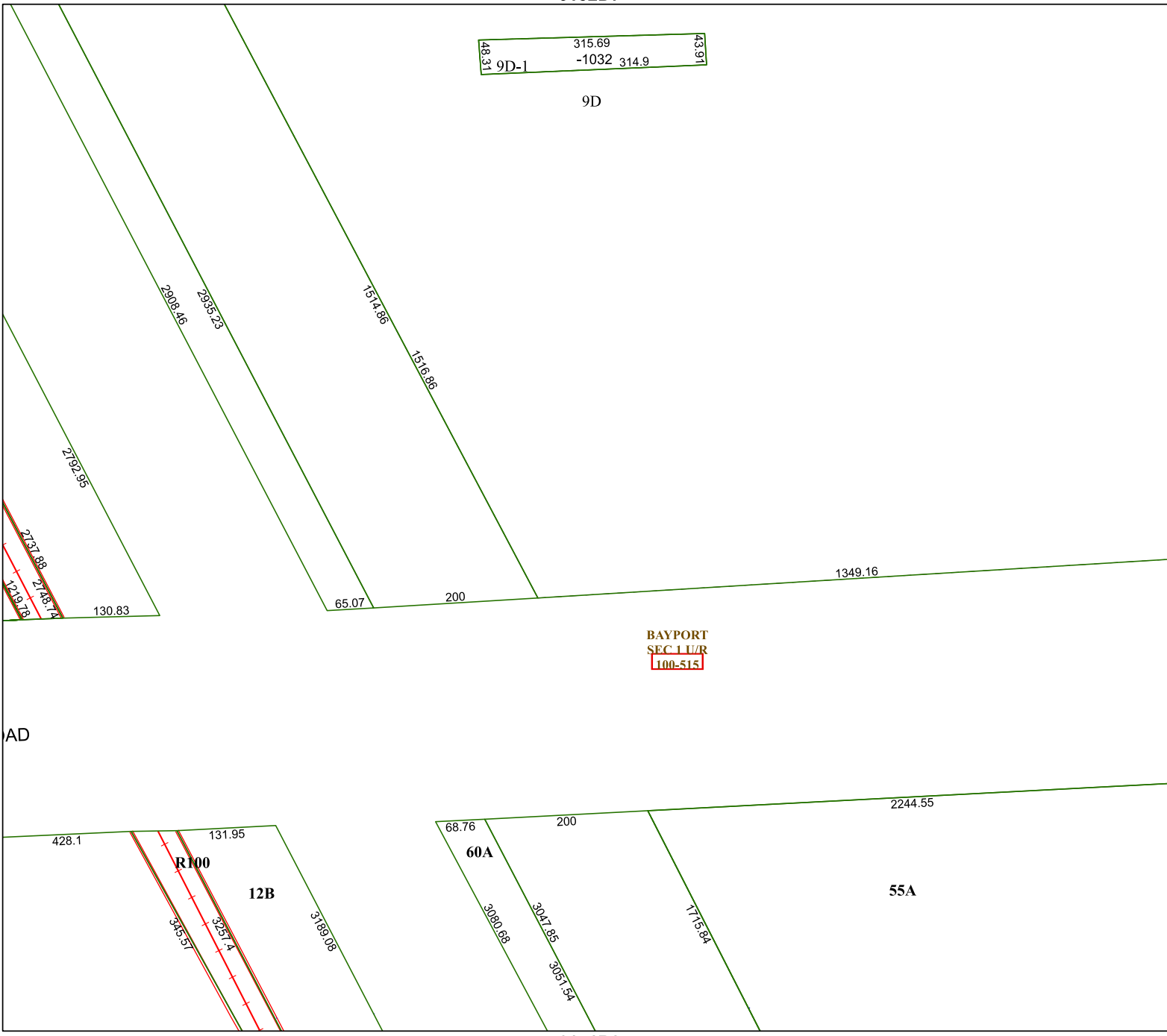

BAYPORT
SEC 11/R
100-515

AD

R100

12B

60A

55A