

6164A6

6164C2

# Harris Central Appraisal District



0 45 90 180 Feet

PUBLICATION DATE: 12/30/2023

Geospatial or map data maintained by the Harris Central Appraisal District is for informational purposes and may not have been prepared for or be suitable for legal, engineering, or surveying purposes. It does not represent an on-the-ground survey and only represents the approximate location of property boundaries.

MAP LOCATION

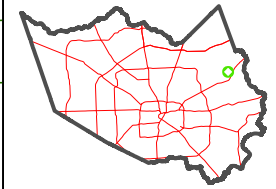

## FACET 6164A10

8	5	6	7	8
12	9	10	11	12
4	1	2	3	4

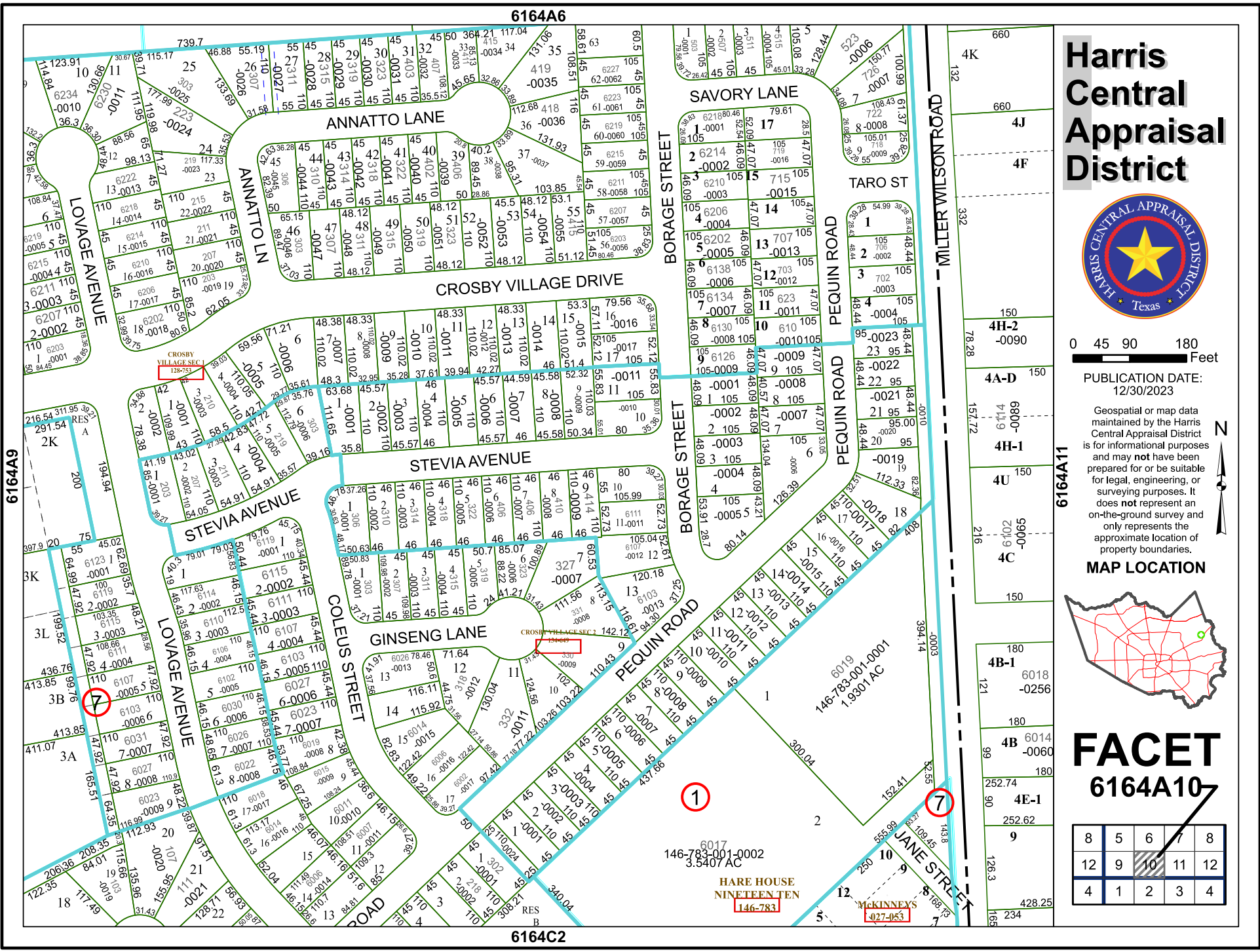

146-783-001-0002  
3.5407 AC  
HARE HOUSE  
NINETEEN TEN  
146-783

146-783-002-0053  
MCKINNEY'S

6164A9

6164B1

