

6170C4

6170C7

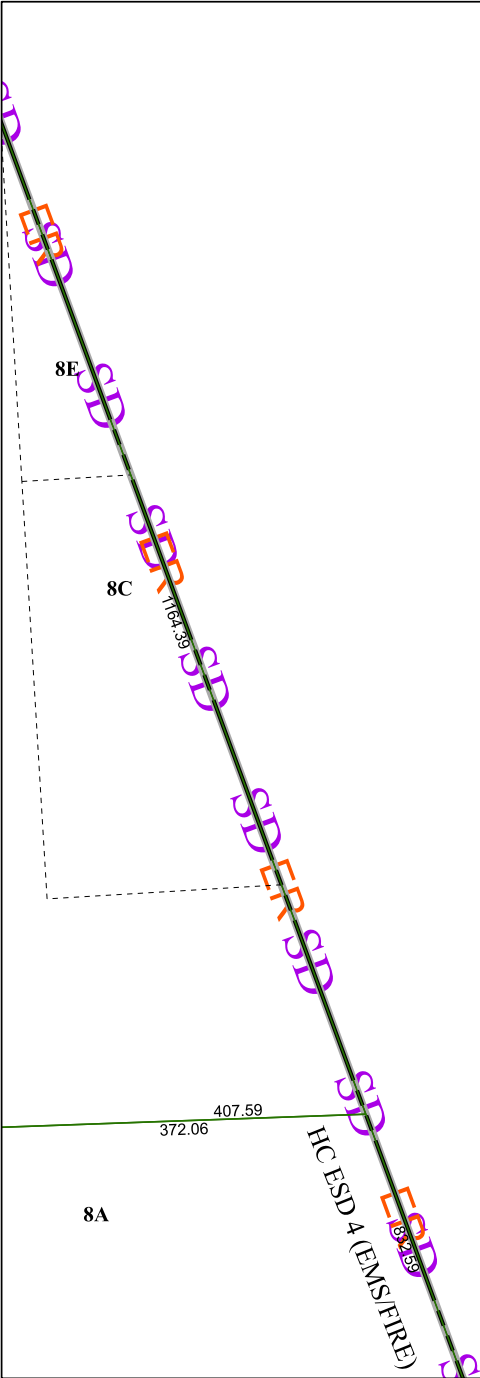

6170C12

# Harris Central Appraisal District



0 45 90 180  
Feet

PUBLICATION DATE:  
1/10/2023

Geospatial or map data maintained by the Harris Central Appraisal District is for informational purposes and may **not** have been prepared for or be suitable for legal, engineering, or surveying purposes. It does **not** represent an on-the-ground survey and only represents the approximate location of property boundaries.



### MAP LOCATION

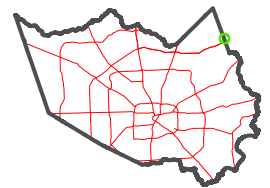

## FACET 6170C8

2	3	4	
6	7	8	
10	11	12	

6170D5