

# Harris Central Appraisal District



0 45 90 180 Feet

PUBLICATION DATE: 12/30/2023

Geospatial or map data maintained by the Harris Central Appraisal District is for informational purposes and may not have been prepared for or be suitable for legal, engineering, or surveying purposes. It does not represent an on-the-ground survey and only represents the approximate location of property boundaries.

MAP LOCATION

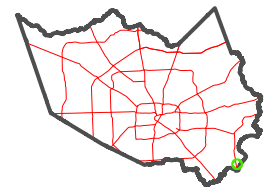

## FACET 6250D9

7	8	5	6	7
11	12	9	10	11
3	4	1	2	3

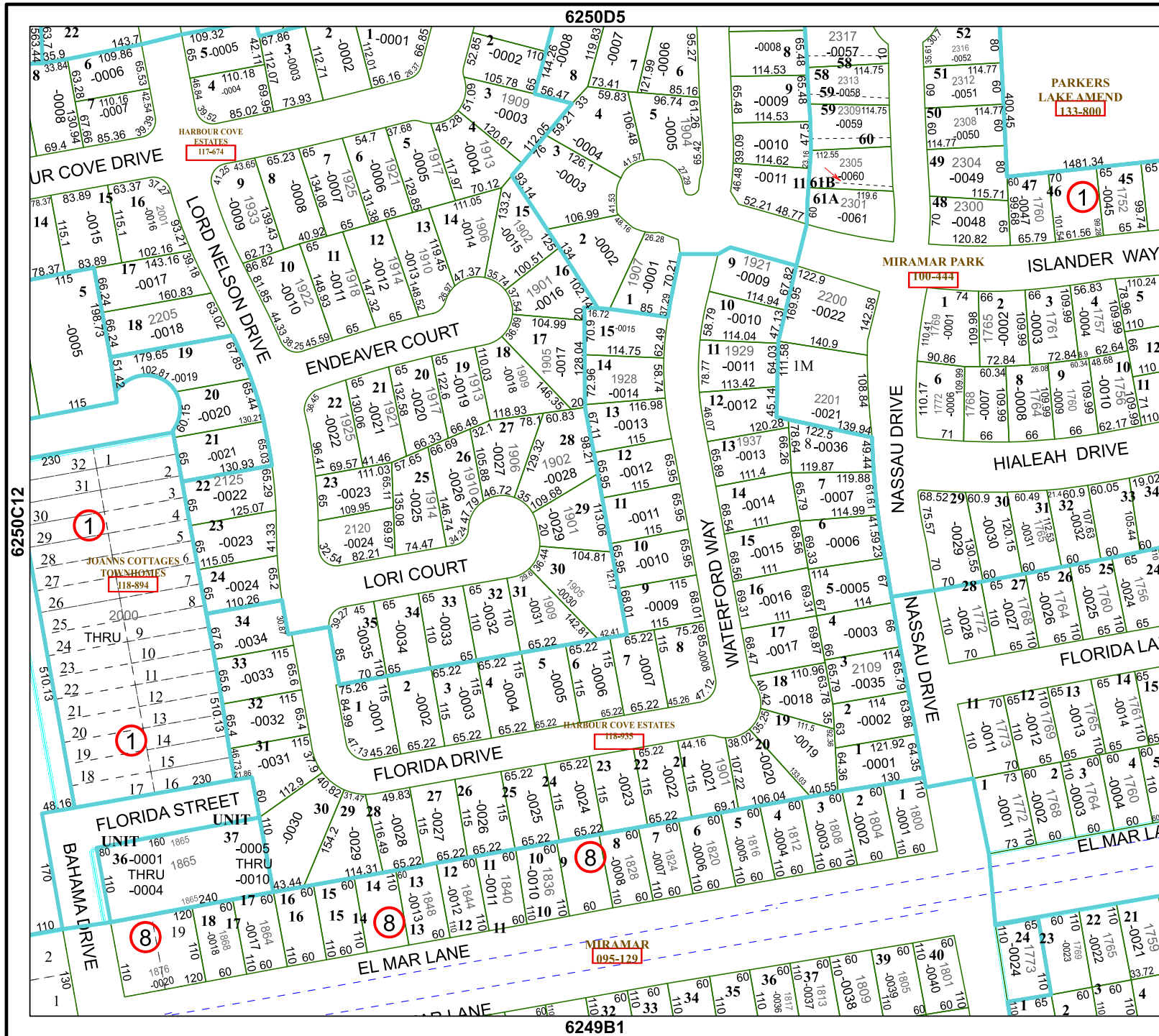

6250D5

PARKERS LAKE AMEND  
133-800

MIRAMAR PARK  
100-444

MIRAMAR  
095-129

6249B1