

6251A5

10800
100-515-000-0355
130.7737 AC

BAYPORT
SEC 11U/R
100-515

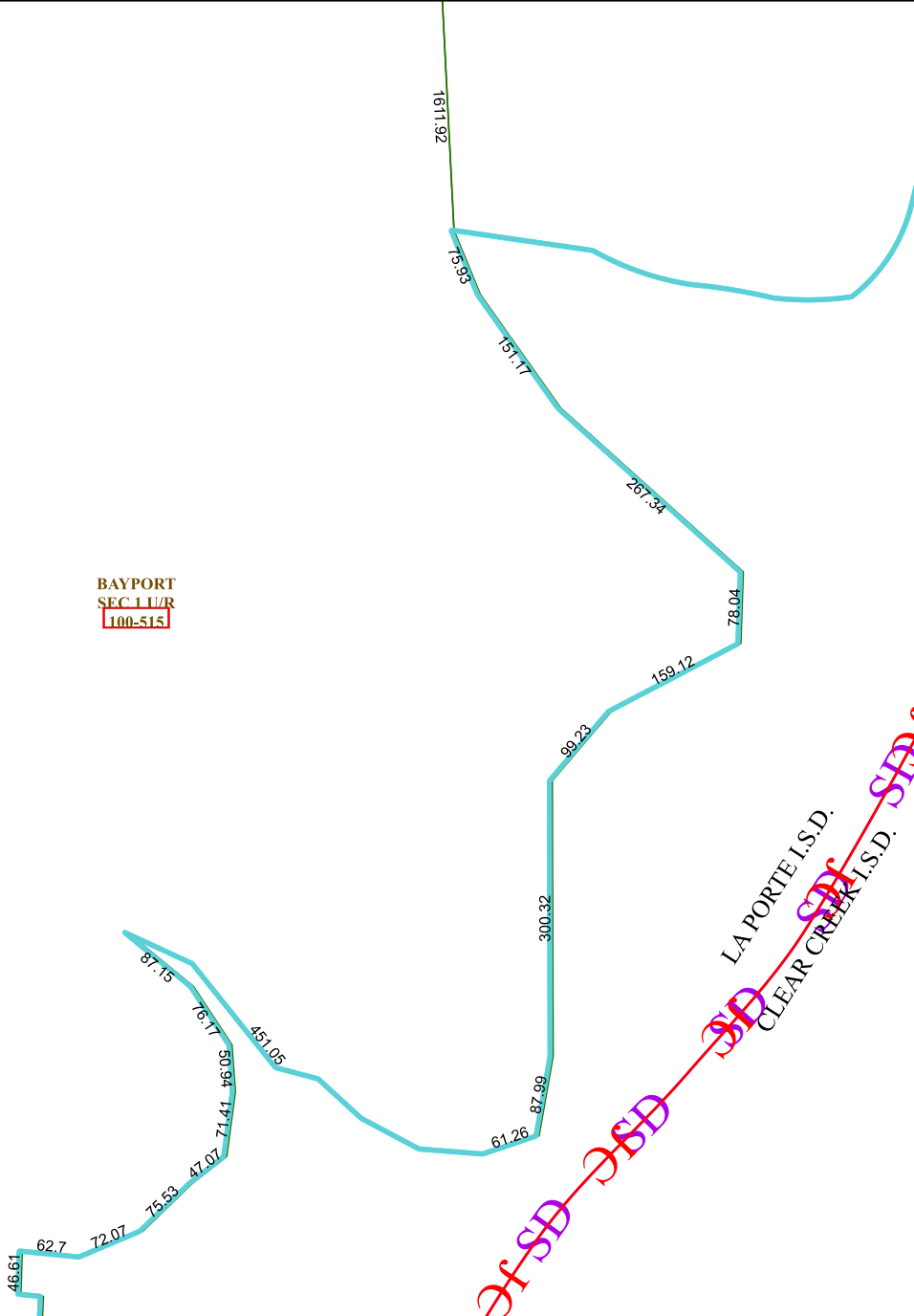

6251C1

Harris Central Appraisal District



0 45 90 180 Feet

PUBLICATION DATE:
1/13/2025

Geospatial or map data maintained by the Harris Central Appraisal District is for informational purposes and may **not** have been prepared for or be suitable for legal, engineering, or surveying purposes. It does **not** represent an on-the-ground survey and only represents the approximate location of property boundaries.



MAP LOCATION

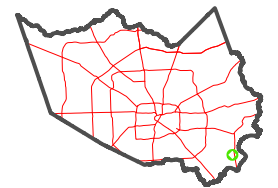

FACET 6251A9

7	8	5	6	7
11	12	9	10	11
3	4	1	2	3

6151B12

6251A10