

6357A1

SAN JACINTO STREET (PRIVATE)

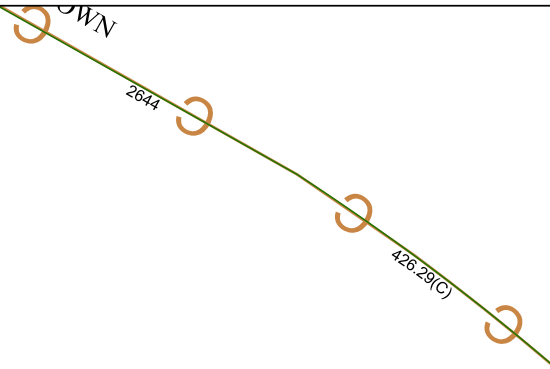

3139
041-022-000-0008
144.3280 AC

6

6357A9

6257B8

Harris Central Appraisal District



0 45 90 180 Feet

PUBLICATION DATE:
2/13/2023

Geospatial or map data maintained by the Harris Central Appraisal District is for informational purposes and may **not** have been prepared for or be suitable for legal, engineering, or surveying purposes. It does **not** represent an on-the-ground survey and only represents the approximate location of property boundaries.



6357A6

MAP LOCATION

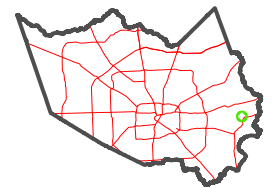

FACET 6357A5

3	4	1	2	3
7	8	5	6	7
11	12	9	10	11