

# Harris Central Appraisal District



0 45 90 180 Feet

PUBLICATION DATE: 2/27/2023

Geospatial or map data maintained by the Harris Central Appraisal District is for informational purposes and may not have been prepared for or be suitable for legal, engineering, or surveying purposes. It does not represent an on-the-ground survey and only represents the approximate location of property boundaries.



MAP LOCATION

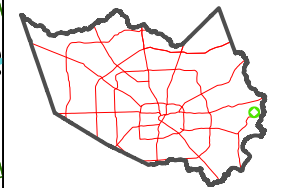

## FACET 6358D4

10	11	12	9	10
2	3	4	1	2
6	7	8	5	6

6358B12

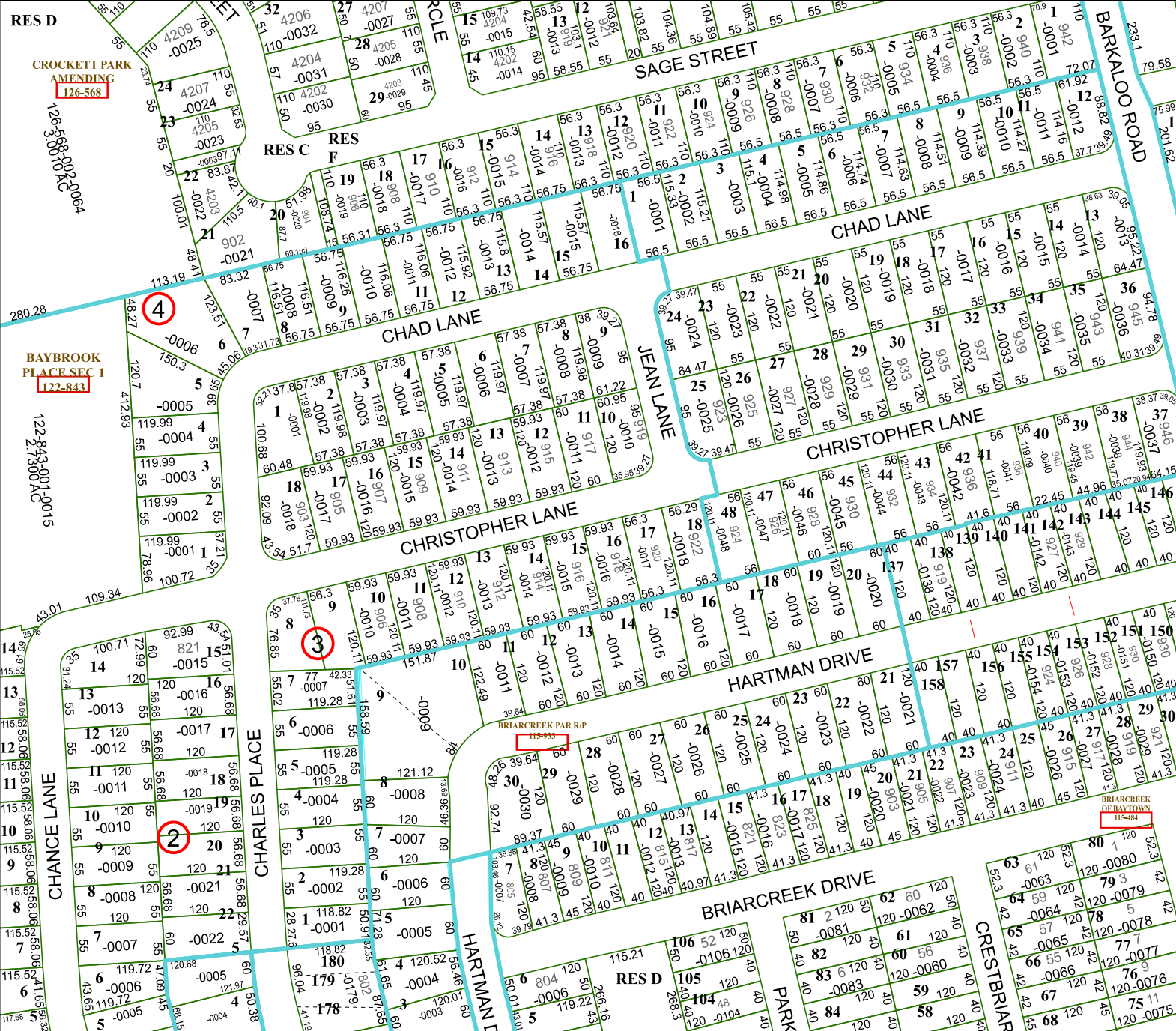

6358D8

RES D

CROCKETT PARK AMENDING 126-568

BAYBROOK PLACE SEC 1 122-843

6358D3

122-843-001015 2,7300AC

CHANCE LANE

CHARLES PLACE

BRIARCREEK PAR RP 115-893

BRIARCREEK OF BAYTOWN 115-484

RES D

RES D

CRESTRIAR PARK