

Harris Central Appraisal District



0 45 90 180 Feet

PUBLICATION DATE: 4/22/2024

Geospatial or map data maintained by the Harris Central Appraisal District is for informational purposes and may not have been prepared for or be suitable for legal, engineering, or surveying purposes. It does not represent an on-the-ground survey and only represents the approximate location of property boundaries.

MAP LOCATION

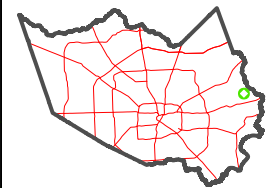

FACET 6361C1

11	12	9	10	11
3	4	1	2	3
7	8	5	6	7

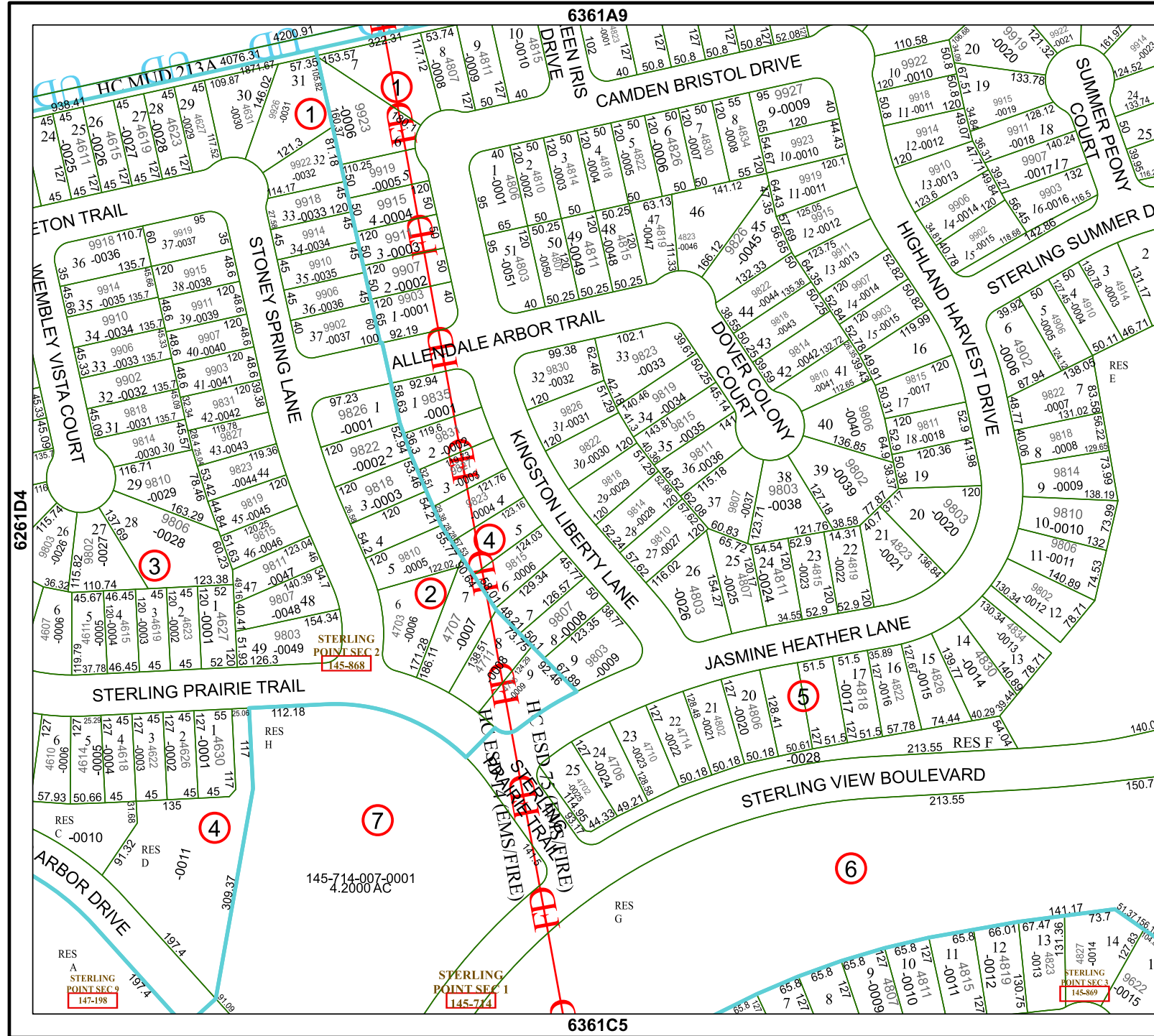

6361A9

6361C5

6261D4

6361C2

STERLING POINT SEC 2
145-868

STERLING POINT SEC 1
145-714

STERLING POINT SEC 3
145-869

STERLING POINT SEC 9
147-198

145-714-007-0001
4.2000 AC