

6361A11

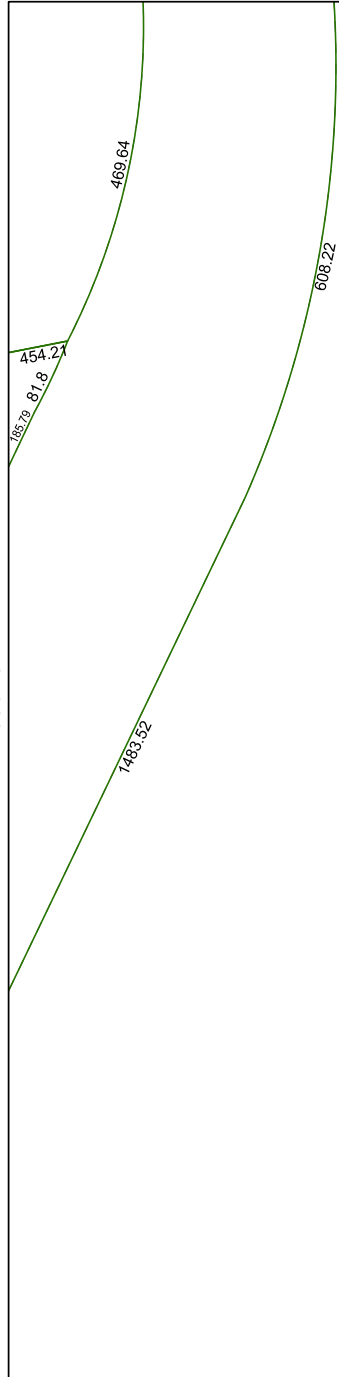

040-221-000-0080  
119.0567 AC

6361C7

# Harris Central Appraisal District



0 45 90 180  
Feet

PUBLICATION DATE:  
1/22/2024

Geospatial or map data maintained by the Harris Central Appraisal District is for informational purposes and may **not** have been prepared for or be suitable for legal, engineering, or surveying purposes. It does **not** represent an on-the-ground survey and only represents the approximate location of property boundaries.



## MAP LOCATION

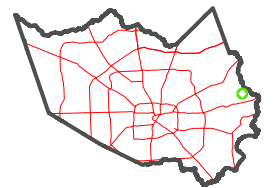

# FACET 6361C3

9	10	11	12	9
1	2	3	4	1
5	6	7	8	5

2841.55  
1206.67

6361C2

6361C4