

Harris Central Appraisal District



0 45 90 180 Feet

PUBLICATION DATE: 1/4/2023

Geospatial or map data maintained by the Harris Central Appraisal District is for informational purposes and may not have been prepared for or be suitable for legal, engineering, or surveying purposes. It does not represent an on-the-ground survey and only represents the approximate location of property boundaries.



MAP LOCATION

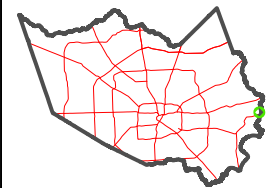

FACET 6458D2

12	9	10	11	12
4	1	2	3	4
8	5	6	7	8

6458B10

6458D6

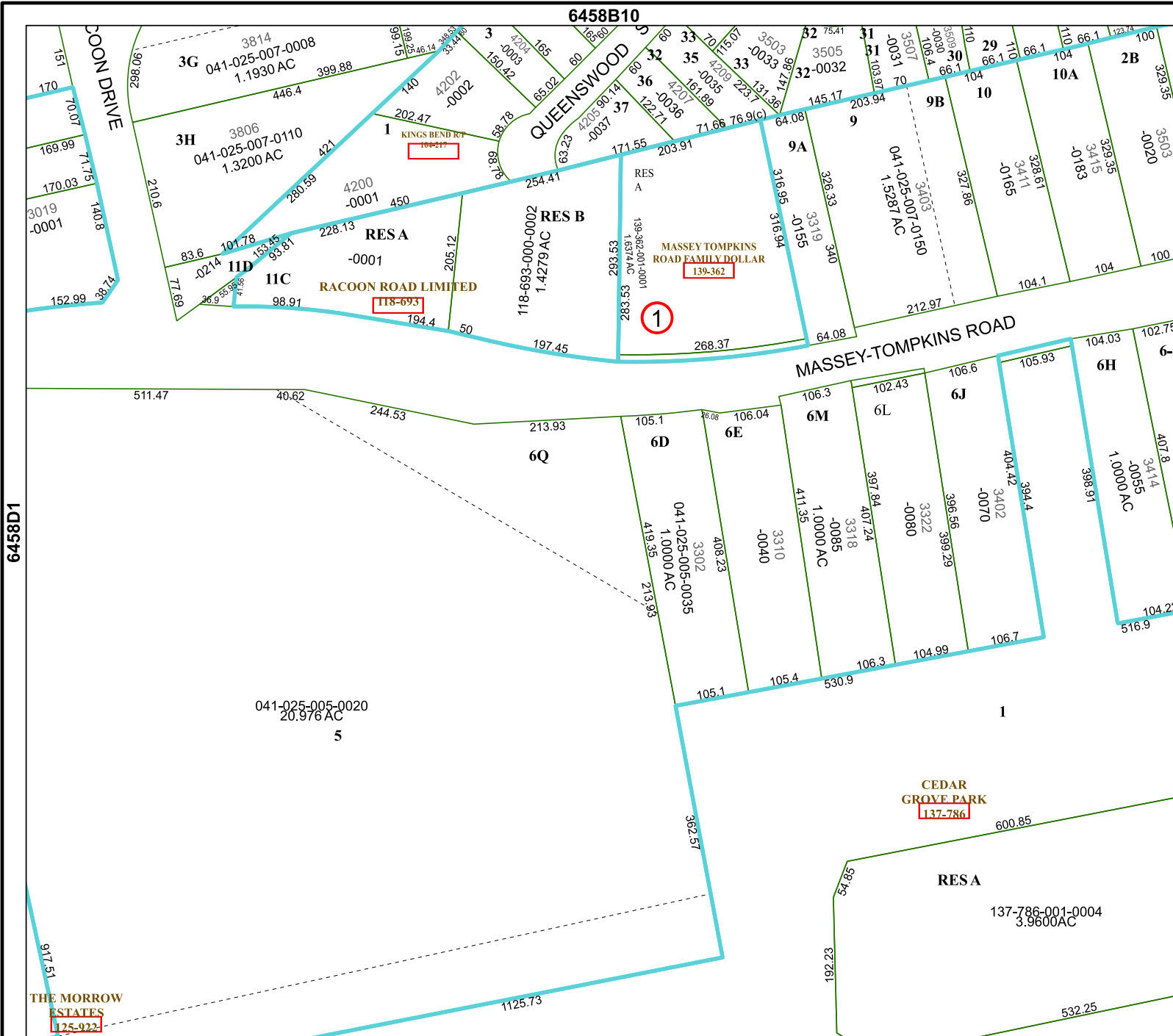

6458D1

6458D3

THE MORROW ESTATES
125-922

CEDAR GROVE PARK
137-786

041-025-005-0020
20.976 AC
5

1

118-693

MASSEY TOMPKINS ROAD FAMILY DOLLAR
139-362

3G 041-025-007-0008
1.1930 AC

3H 3806
041-025-007-0110
1.3200 AC

RES A
-0001

RES B
1.4279 AC

RACCOON ROAD LIMITED

MASSEY TOMPKINS ROAD FAMILY DOLLAR
139-362

RES A
137-786-001-0004
3.9600 AC

137-786-001-0004
3.9600 AC

COON DRIVE

QUEENSWOOD

MASSEY-TOMPKINS ROAD

CEDAR GROVE PARK
137-786

RES A

THE MORROW ESTATES
125-922