

Harris Central Appraisal District



0 45 90 180 Feet

PUBLICATION DATE:
4/3/2023

Geospatial or map data maintained by the Harris Central Appraisal District is for informational purposes and may not have been prepared for or be suitable for legal, engineering, or surveying purposes. It does not represent an on-the-ground survey and only represents the approximate location of property boundaries.



MAP LOCATION

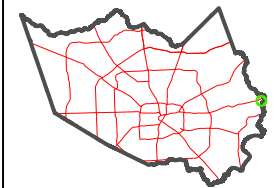

FACET 6460D6

4	1	2	3	4
8	5	6	7	8
12	9	10	11	12

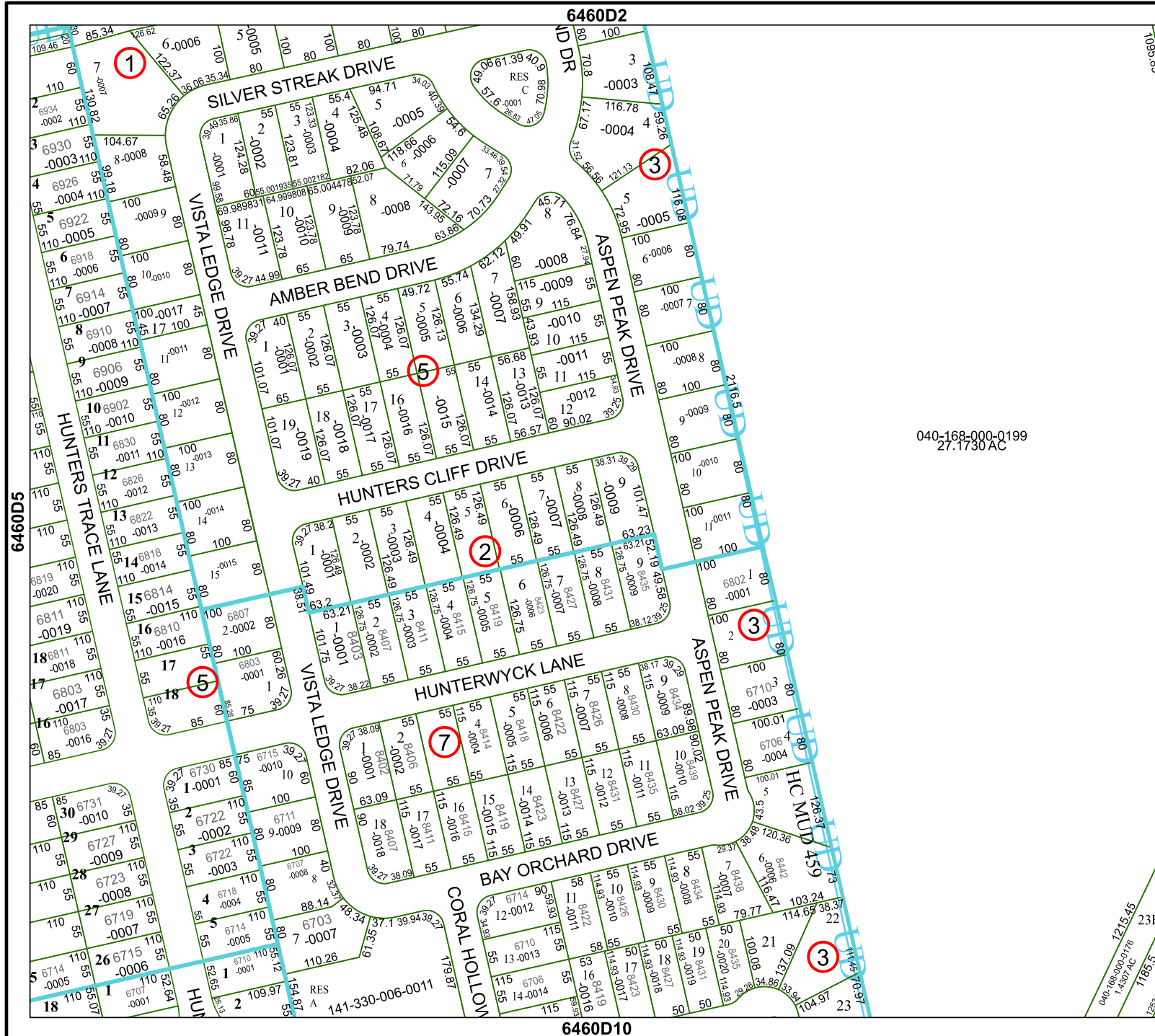

040-168-000-0199
27.1730 AC

1095.85

6460D7

040-168-000-0176
1.4807 AC
1215.45
23B
7185.5
1233.4

6460D10